



# CHAMPAIGN COUNTY COURTHOUSE & JUVENILE DETENTION CENTER

## SECURITY CAMERA AND DETENTION MONITORING SYSTEM REPLACEMENT

CHAMPAIGN COUNTY COURTHOUSE  
101 E. MAIN STREET  
URBANA, IL 61801

JUVENILE DETENTION CENTER  
400 ART BARTELL RD.  
URBANA, IL 61802

### ENGINEER:



### OWNER:



DRAWING LIST	
SHEET NUMBER	SHEET NAME
C100	COVER SHEET
T100	COURTHOUSE - TECHNOLOGY NOTES AND SYMBOLS
TD102.1	COURTHOUSE - PARTIAL BASEMENT DEMO PLAN - AREA B - TECHNOLOGY
TD111.1	COURTHOUSE - PARTIAL FIRST FLOOR DEMO PLAN - AREA A - TECHNOLOGY
TD112.1	COURTHOUSE - PARTIAL FIRST FLOOR DEMO PLAN - AREA B - TECHNOLOGY
TD121.1	COURTHOUSE - PARTIAL SECOND DEMO PLAN - AREA A - TECHNOLOGY
TD122.1	COURTHOUSE - PARTIAL SECOND DEMO PLAN - AREA B - TECHNOLOGY
TD131.1	COURTHOUSE - PARTIAL THIRD FLOOR DEMO PLAN - AREA A - TECHNOLOGY
TD132.1	COURTHOUSE - PARTIAL THIRD FLOOR DEMO PLAN - AREA B - TECHNOLOGY
T102.1	COURTHOUSE - PARTIAL BASEMENT FLOORPLAN - AREA A - TECHNOLOGY
T111.1	COURTHOUSE - PARTIAL FIRST FLOOR FLOORPLAN - AREA A - TECHNOLOGY
T112.1	COURTHOUSE - PARTIAL FIRST FLOOR FLOORPLAN - AREA B - TECHNOLOGY
T121.1	COURTHOUSE - PARTIAL SECOND FLOOR FLOORPLAN - AREA A - TECHNOLOGY
T122.1	COURTHOUSE - PARTIAL SECOND FLOOR FLOORPLAN - AREA B - TECHNOLOGY
T131.1	COURTHOUSE - PARTIAL THIRD FLOOR FLOORPLAN - AREA A - TECHNOLOGY
T132.1	COURTHOUSE - PARTIAL THIRD FLOOR FLOORPLAN - AREA B - TECHNOLOGY
TD111.2	J.D.C. - FIRST FLOOR PLAN - DEMOLITION - TECHNOLOGY
TD112.2	J.D.C. - MEZANINE PLAN - DEMOLITION - TECHNOLOGY
T111.2	J.D.C. - FIRST FLOOR PLAN - NEW WORK - TECHNOLOGY
T112.2	J.D.C. - MEZANINE PLAN - NEW WORK - TECHNOLOGY

DATE	NO.	DESCRIPTION

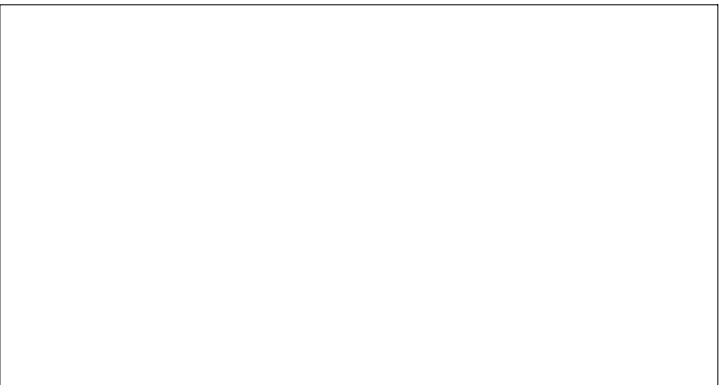

COVER SHEET	
CHAMPAIGN COUNTY COURTHOUSE & JUVENILE DETENTION CENTER- SECURITY CAMERA AND MASTER CONTROL SYSTEMS UPGRADE	
CHAMPAIGN COUNTY 101 E MAIN STREET, URBANA, IL 61801	

SHEET:	DATE:	DES	LEM
	12/4/2019		
	BID DOCUMENTS		
	GHR # 7257		
C100			

12/3/2019 4:25:04 PM  
C:\Users\dschultz\Documents\7257 - CC COURTHOUSE CAMERAS & MCS REPLACEMENT - MEP19 - CENTRAL\_DSchultz.rvt  
GHR # 7257 - CHAMPAIGN COUNTY COURTHOUSE & JUVENILE DETENTION CENTER SECURITY CAMERA AND MASTER CONTROL SYSTEMS UPGRADE

ABBREVIATIONS					
A OR AMP	AMPERE OR AMPLIFIER	GEN	GENERATOR	SPDT	SINGLE POLE DOUBLE THROW
AC	ALTERNATING CURRENT	GFI	GROUND FAULT INTERRUPTER	SPST	SINGLE POLE SINGLE THROW
AC	ABOVE COUNTER	GFCI	GROUND FAULT CIRCUIT INTERRUPTER	SPKR	SPEAKER
AFG	ABOVE FINISH GRADE	GRC	GALVANIZED RIGID CONDUIT	SPEC	SPECIFICATION
AIC	AMPERES INTERRUPTING CAPACITY	H	HANDICAP MOUNTED AT 48" AFF	SS	STAINLESS STEEL
AL	ALUMINUM	HACR	HEATING, AIR CONDITIONING, REFRIGERATION RATED	ST	SHUNT TRIP
ANN	ANNUNCIATOR	HQA	HAND-OFF-AUTO SELECTOR	STCB	SHUNT TRIP CIRCUIT BREAKER
ATS	AUTOMATIC TRANSFER SWITCH	HP	HORSEPOWER	SWBD	SWITCHBOARD
BAS	BUILDING AUTOMATION SYSTEM	HV	HIGH VOLTAGE	SWGR	SWITCHGEAR
B DG	BUILDING DISTRIBUTION FRAME	HZ	HERTZ (CYCLES/SECOND)	SYM	SYMMETRICAL
BFC	BELOW FINISH CEILING	IDF	INTERMEDIATE DISTRIBUTION FRAME	TGB	TELECOM GROUND BAR
BFG	BELOW FINISH GRADE	IMC	INTERMEDIATE GRADE CONDUIT	TMGB	TELECOM MAIN GROUND BAR
C	CONDUIT	JB	JUNCTION BOX	TR	TELECOM ROOM
CATV	CABLE TELEVISION	KO	KNOCKOUT	TTC	TELEPHONE TERMINAL CABINET
CB	CIRCUIT BREAKER	KVA	KILO VOLT-AMPERE	TV	TELEVISION, CEILING OR WALL MOUNTED
CCT	CIRCUIT	KW	KILOWATT	TVSS	TRANSIENT VOLTAGE SURGE SUPPRESSION
CCTV	CLOSED CIRCUIT TELEVISION CAMERA	KWH	KILOWATT-HOUR	TYP	TYPICAL
CD	CANDELA	LED	LIGHT EMITTING DIODE	UH	UNIT HEATER
CEC	CHICAGO ELECTRIC CODE	LTG	LIGHTING	UNO	UNLESS NOTED OTHERWISE
COAX	COAXIAL	LV	LOW VOLTAGE	VFD	VARIABLE FREQUENCY DRIVE
COF	COFFEE MAKER	MAN	MANUAL	V	VOLT
CPT	CONTROL POWER POTENTIAL TRANSFORMER	MAG	MAGNETIC	VA	VOLT-AMPERE
CR	CARD READER	MCA	MINIMUM CIRCUIT AMPERES	W	WALL MOUNTED AT INDICATED DIMENSION AFF
CSDS	COMBINATION STARTER/DISCONNECT SWITCH	MCC	MOTOR CONTROL CENTER	WAP	WIRELESS ACCESS POINT
CT	CURRENT TRANSFORMER	MDF	MAIN DISTRIBUTION FRAME	WP	INDICATES WEATHER OR WATERPROOF
CU	COPPER	MER	MAIN EQUIPMENT ROOM	WPFDS	WEATHERPROOF FUSED DISCONNECT SWITCH
CUH	CABINET UNIT HEATER	MFR	MANUFACTURER	WPNFDS	WEATHERPROOF NON FUSED DISCONNECT SWITCH
D	INDICATES DIMMER SWITCH	MH	MANHOLE	XFMR	TRANSFORMER
DC	DIRECT CURRENT	MMS	MANUAL MOTOR STARTER		
DH	MAGNETIC DOOR HOLD OPEN	MOC	MAXIMUM OVERCURRENT PROTECTION		
DO	DRAWOUT	MTD	MOUNTED		
DPDT	DOUBLE POLE DOUBLE THROW	MTR	MOTOR		
DPST	DOUBLE POLE SINGLE THROW	MW	MICROWAVE		
DS	DISCONNECT SWITCH	N	NEUTRAL		
DW	DISHWASHER	NC	NORMALLY CLOSED		
ELEC	ELECTRIC	NFC	NATIONAL ELECTRIC CODE		
EM	EMERGENCY	NFDS	NON-FUSED DISCONNECT SWITCH		
EMS	ENERGY MANAGEMENT SYSTEM	NIC	NOT IN CONTRACT		
EMT	ELECTRIC METALLIC TUBING	NO	NORMALLY OPENED		
EN	EXISTING LOCATION NEW DEVICE	NTS	NOT TO SCALE		
EOL	END OF LINE DEVICE	OCP	OVERCURRENT PROTECTION		
EQ	EQUAL	P	POLE		
EQUIP	EQUIPMENT	PA	PUBLIC ADDRESS		
ER	EXISTING TO BE REMOVED	PB	PULL BOX		
ERL	EXISTING TO BE RELOCATED	PB	PUSH BUTTON		
ERN	EXISTING DEVICE TO BE RELOCATED	PCU	PACKAGED CONTROL UNIT		
EUH	ELECTRIC UNIT HEATER	PH	PHASE		
EW	ELECTRIC WATER COOLER	PL	PILOT LIGHT		
EW	ELECTRIC WATER HEATER	PRI	PRIMARY		
EX	EXISTING	PT	POTENTIAL TRANSFORMER		
FPB	FAN POWERED BOX	PVC	POLYVINYL CHLORIDE		
FA	FIRE ALARM	PWR	POWER		
FACP	FIRE ALARM CONTROL PANEL	REF	REFRIGERATOR		
FAAP	FIRE ALARM ANNUNCIATOR PANEL	RCPT	RECEPTACLE		
FCCP	FIRE COMMAND CONTROL PANEL	RVNR	REDUCED VOLTAGE NON-REVERSING		
FDS	FUSED DISCONNECT SWITCH	RVR	REDUCED VOLTAGE REVERSING		
FLA	FULL LOAD AMPS	SD	SMOKE DAMPER OR DETECTOR		
FLUOR	FLUORESCENT	SEC	SECONDARY		
FS	FUSED SWITCH	SFD	SMOKE / FIRE DAMPER		
FVNR	FULL VOLTAGE NON-REVERSING	SPC	SINGLE POINT CONNECTION		
FVR	FULL VOLTAGE REVERSING	SP	SINGLE POLE		
G OR GRD	GROUND				

GENERAL NOTES

1. WORK, MATERIALS AND EQUIPMENT SHALL CONFORM TO THE LATEST EDITIONS OF LOCAL, STATE AND FEDERAL CODES AND ORDINANCES.
2. DRAWINGS ARE DIAGRAMMATIC ONLY AND REPRESENT THE GENERAL SCOPE OF THE WORK. REVIEW THE GENERAL NOTES, SPECIFICATIONS AND PLANS FOR ADDITIONAL REQUIREMENTS THAT MAY NOT BE SPECIFICALLY CALLED OUT IN THIS PORTION OF THE CONSTRUCTION DOCUMENTS. NOTIFY THE ARCHITECT OR ENGINEER OF ANY CONFLICTS OR DISCREPANCIES PRIOR TO SUBMISSION OF BID.
3. CONTRACTOR SHALL FIELD VERIFY DIMENSIONS OF FINISHED CONSTRUCTION PRIOR TO FABRICATION AND INSTALLATION OF FIXTURES AND EQUIPMENT. CONTRACTOR SHALL REVIEW ARCHITECTURAL, STRUCTURAL, MECHANICAL AND OTHER DRAWINGS PRIOR TO BID.
5. MAINTAIN ACCURATE RECORDS OF ALL CHANGES MADE DURING CONSTRUCTION. PROVIDE A NEATLY MARKED SET OF BLUEPRINTS TO THE ENGINEER/ARCHITECT AT COMPLETION OF THE PROJECT, INDICATING ALL FIELD CHANGES.
6. PROPOSED SUBSTITUTIONS OF ELECTRICAL EQUIPMENT OR REQUEST FOR "OR EQUAL" OR "APPROVED EQUAL" LISTING SHALL BE SUBMITTED TO ARCHITECT NOT LESS THAN TEN (10) WORKING DAYS PRIOR TO BID.
7. ALL WORK SHALL BE INSTALLED CONCEALED UNLESS OTHERWISE NOTED.
8. FINAL LOCATION OF CEILING MOUNTED EQUIPMENT SHALL BE IN ACCORDANCE WITH ARCHITECTURAL REFLECTED CEILING PLANS.
9. ELECTRICAL CONTRACTOR SHALL VISIT THE JOB SITE TO MAKE HIMSELF AWARE OF EXISTING CONDITIONS BEFORE SUBMITTING HIS PRICE. COORDINATE WITH OTHER TRADES TO DETERMINE THE EXACT LOCATION OF MOTORS, MOTOR TERMINAL BOXES, AND OTHER EQUIPMENT TO BE INSTALLED BY OTHER TRADES BEFORE CONDUIT WORK IS STARTED. REFER TO MECHANICAL DRAWINGS FOR LOCATIONS OF ALL MECHANICAL EQUIPMENT. NO LOW VOLTAGE WIRING SHALL BE PERMITTED IN THE SAME RACEWAY AS LINE VOLTAGE POWER WIRING.
12. AT ALL EMPTY CONDUITS PROVIDE BUSHINGS AT ENDS AND DRAG WIRES. PROVIDE SEPARATE NEUTRALS FOR ALL 120 AND 277 VOLT BRANCH CIRCUITS. SHARED NEUTRALS IS NOT ALLOWED.
14. ALL BRANCH CIRCUIT WIRING SHALL BE ROUTED CONCEALED IN WALLS AND IN HUNG CEILING CAVITY, U.O.N. WHERE EXPOSED CONDUITS CANNOT BE AVOIDED, ROUTE ALL SUCH CONDUITS IN A NEAT MANNER FOLLOWING BUILDING STRUCTURAL LINES. COORDINATE ROUTING WITH OTHER TRADES. ALL PENETRATIONS INTO FIRE-RATED WALLS OR CORE HOLES BETWEEN FLOOR SLABS MUST BE PROPERLY FIRE-STOPPED IN ACCORDANCE WITH THE GUIDELINES OF THE NATIONAL ELECTRICAL CODE AND LOCAL BUILDING CODES. COORDINATE INSTALLATION OF NEW SERVICES WITH LOCAL ELECTRICAL UTILITY COMPANY. PROVIDE ALL TRENCHING, CONDUIT, METER CENTERS, CONCRETE PADS, AND OTHER ITEMS AS REQUIRED.
15. RECEPTACLE OUTLETS IN A BACK TO BACK CONFIGURATION AS SHOWN ON PLANS SHALL BE OFFSET A MINIMUM OF 24 INCHES OC. THRU-WALL BOXES ARE PROHIBITED

DEMOLITION NOTES

1. DISCONNECT AND REMOVE ELECTRICAL ITEMS AND ASSOCIATED CONDUIT, WIRING, ETC AS SHOWN OR NOTED.
2. DISCONNECT AND REMOVE ALL DEVICES, CONDUIT, WIRING, ETC ASSOCIATED WITH LIGHTING AND POWER SYSTEMS BEING REMOVED.
3. DISCONNECT AND REMOVE ALL DEVICES, CONDUIT, WIRING, ETC ASSOCIATED WITH MECHANICAL EQUIPMENT BEING REMOVED.
4. DISCONNECT AND REMOVE ALL DEVICES, CONDUIT, WIRING, ETC IN OR ON THE WALLS, CEILING, ETC TO BE REMOVED. VERIFY ALL OCCURRENCES NOT SPECIFICALLY SHOWN OR NOTED ON PLANS.
5. BE RESPONSIBLE FOR CONTINUITY OF ALL EXISTING POWER AND LIGHTING CIRCUITS AND SYSTEMS OF ALL REMAINING DEVICES AND SYSTEMS WHICH MAY BE AFFECTED BY REMODELING.
6. FOR EACH ITEM DISCONNECTED AND REMOVED, DISCONNECT AND REMOVE DEFUNCT CIRCUIT WIRING BACK TO NEXT ACTIVE REMAINING DEVICE OR TO PANEL OR SWITCHBOARD FROM WHICH THE CIRCUIT ORIGINATES.
7. FOR EACH ITEM DISCONNECTED AND REMOVED, DISCONNECT AND REMOVE ABANDONED, EXPOSED CONDUITS, AND/OR CONDUITS MADE EXPOSED BY DEMOLITION, BACK TO NEXT ACTIVE REMAINING DEVICE OR TO PANEL OR SWITCHBOARD FROM WHICH THE CIRCUIT ORIGINATES.
8. EXCEPT WHERE OTHERWISE NOTED, ALL REMOVED ELECTRICAL EQUIPMENT, DEVICES, CONDUIT, CONDUCTORS, FIXTURES, AND ASSOCIATED ITEMS SHALL BECOME THE PROPERTY OF THE ELECTRICAL CONTRACTOR AND SHALL BE DISPOSED OF BY HIM.
9. CO-ORDINATE DISCONNECTION AND REMOVAL OF EXISTING DOOR ACCESS AND SECURITY DEVICES WITH THE GENERAL TRADE. REMOVE AND STORE ELECTRICAL DOOR DEVICES SUCH AS CARD READERS, POWER SUPPLIES, POSITION SWITCHES, SENSORS ETC, FOR REUSE AS SHOWN ON NEW WORK PLANS.

SYMBOL SCHEDULE

	DETENTION INTERCOM STATION - UNLESS OTHERWISE NOTED EXISTING DEVICE AND ASSOCIATED WIRING AND RELAYS TO REMAIN. CONTRACTOR TO INTEGRATE EXISTING DEVICE INTO NEW INTERCOMMUNICATION SYSTEM.
	DETENTION INTERCOMMUNICATION ONE-WAY PAGING SPEAKER - EXISTING DEVICE AND ASSOCIATED WIRING AND RELAYS TO REMAIN. CONTRACTOR TO INTEGRATE EXISTING DEVICE INTO NEW INTERCOMMUNICATION SYSTEM.
	VIDEO SURVEILLANCE CAMERA - CONTRACTOR TO DISCONNECT AND REMOVE EXISTING CAMERAS AND ASSOCIATED WIRING AS SHOWN ON DEMOLITION PLANS. PROVIDE NEW IP CAMERAS AND CABLING. CIRCUIT AS SHOWN CAMERA TYPE - SEE CAMERA SCHEDULE PATCH PANEL PORT NUMBER PATCH PANEL DESIGNATION NETWORK ROOM IDENTIFIER
	ACCESS CONTROL DOOR LOCK - EXISTING DEVICE AND ASSOCIATED WIRING AND RELAYS TO REMAIN. CONTRACTOR TO INTEGRATE EXISTING DEVICE INTO NEW ACCESS CONTROL SYSTEM.
	DURESS PUSHBUTTON - EXISTING DEVICE AND ASSOCIATED WIRING AND RELAYS TO REMAIN. CONTRACTOR TO INTEGRATE EXISTING DEVICE INTO NEW DETENTION MONITORING AND CONTROL SYSTEM.
	ACCESS CONTROL KEY PAD - CONTRACTOR TO DISCONNECT AND REMOVE EXISTING DEVICE SHOWN ON DEMOLITION PLANS. EXISTING WIRING AND RELAYS TO REMAIN. PROVIDE NEW DEVICE SIMILAR IN FUNCTION TO EXISTING AND INTEGRATE IT INTO NEW ACCESS CONTROL SYSTEM.
	ACCESS CONTROL PUSH BUTTON - EXISTING DEVICE AND ASSOCIATED WIRING AND RELAYS TO REMAIN. CONTRACTOR TO INTEGRATE EXISTING DEVICE INTO NEW DETENTION MONITORING AND CONTROL SYSTEM.
	ACCESS CONTROL BADGE READER - CONTRACTOR TO DISCONNECT AND REMOVE EXISTING DEVICE SHOWN ON DEMOLITION PLANS. EXISTING WIRING AND RELAYS TO REMAIN. PROVIDE NEW DEVICE SIMILAR IN FUNCTION TO EXISTING AND INTEGRATE IT INTO NEW ACCESS CONTROL SYSTEM.
	CONTROL POINT FOR MASTER CONTROL SYSTEM - PLUMBING/WATER • THIS SYMBOL INDICATES THE EXISTING MASTER CONTROL SYSTEM CURRENTLY ALLOWS FOR ON/OFF FUNCTIONALITY FOR THE LIGHTING SERVING THE SPACE THIS SYMBOL OCCUPIES. • NEW MASTER CONTROL SYSTEM TO RECONNECT TO ALL EXISTING RELAYS AND CONTROL MODULES AND TO REGAIN THIS FUNCTIONALITY.
	CONTROL POINT FOR MASTER CONTROL SYSTEM - RECEPTACLES/ELECTRICAL • THIS SYMBOL INDICATES THE EXISTING MASTER CONTROL SYSTEM CURRENTLY ALLOWS FOR ON/OFF FUNCTIONALITY FOR THE RECEPTACLES SERVING SPACE THIS SYMBOL OCCUPIES. • NEW MASTER CONTROL SYSTEM TO RECONNECT TO ALL EXISTING RELAYS AND CONTROL MODULES AND TO REGAIN THIS FUNCTIONALITY.
	CONTROL POINT FOR MASTER CONTROL SYSTEM - PLUMBING/WATER • THIS SYMBOL INDICATES THE EXISTING MASTER CONTROL SYSTEM CURRENTLY ALLOWS FOR ON/OFF FUNCTIONALITY FOR THE PLUMBING AND/OR WATER SERVING SPACE THIS SYMBOL OCCUPIES. • NEW MASTER CONTROL SYSTEM TO RECONNECT TO ALL EXISTING RELAYS AND CONTROL MODULES AND TO REGAIN THIS FUNCTIONALITY.

SECURITY CAMERA SCHEDULE

DEVICE TAG	DEVICE TYPE	CAMERA MOUNT	CAMERA LOCATION
A	2 MEGAPIXEL DOME CAMERA	CEILING MOUNT	INTERIOR
B	5 MEGAPIXEL DOME CAMERA	CEILING MOUNT	INTERIOR
C	8 MEGAPIXEL PANORAMIC CAMERA	CEILING MOUNT	INTERIOR
D	8 MEGAPIXEL PANORAMIC CAMERA	EXTERIOR WALL	EXTERIOR
E	2 MEGAPIXEL DOME CAMERA	EXTERIOR CEILING	EXTERIOR
F	5 MEGAPIXEL DOME CAMERA	EXTERIOR WALL	EXTERIOR
G	2 MEGAPIXEL DOME CAMERA WITH MICROPHONE	CEILING MOUNT	INTERIOR
H	15 MEGAPIXEL PANORAMIC CAMERA	EXTERIOR WALL	EXTERIOR
I	15 MEGAPIXEL PANORAMIC CAMERA	PARAPET MOUNT TO ROOF	EXTERIOR
J	15 MEGAPIXEL PANORAMIC CAMERA	PENDANT MOUNT TO POLE	EXTERIOR
K	5 MEGAPIXEL DOME CAMERA	PARAPET MOUNT TO ROOF	EXTERIOR
L	5 MEGAPIXEL BULLET CAMERA	PARAPET MOUNT TO ROOF	EXTERIOR

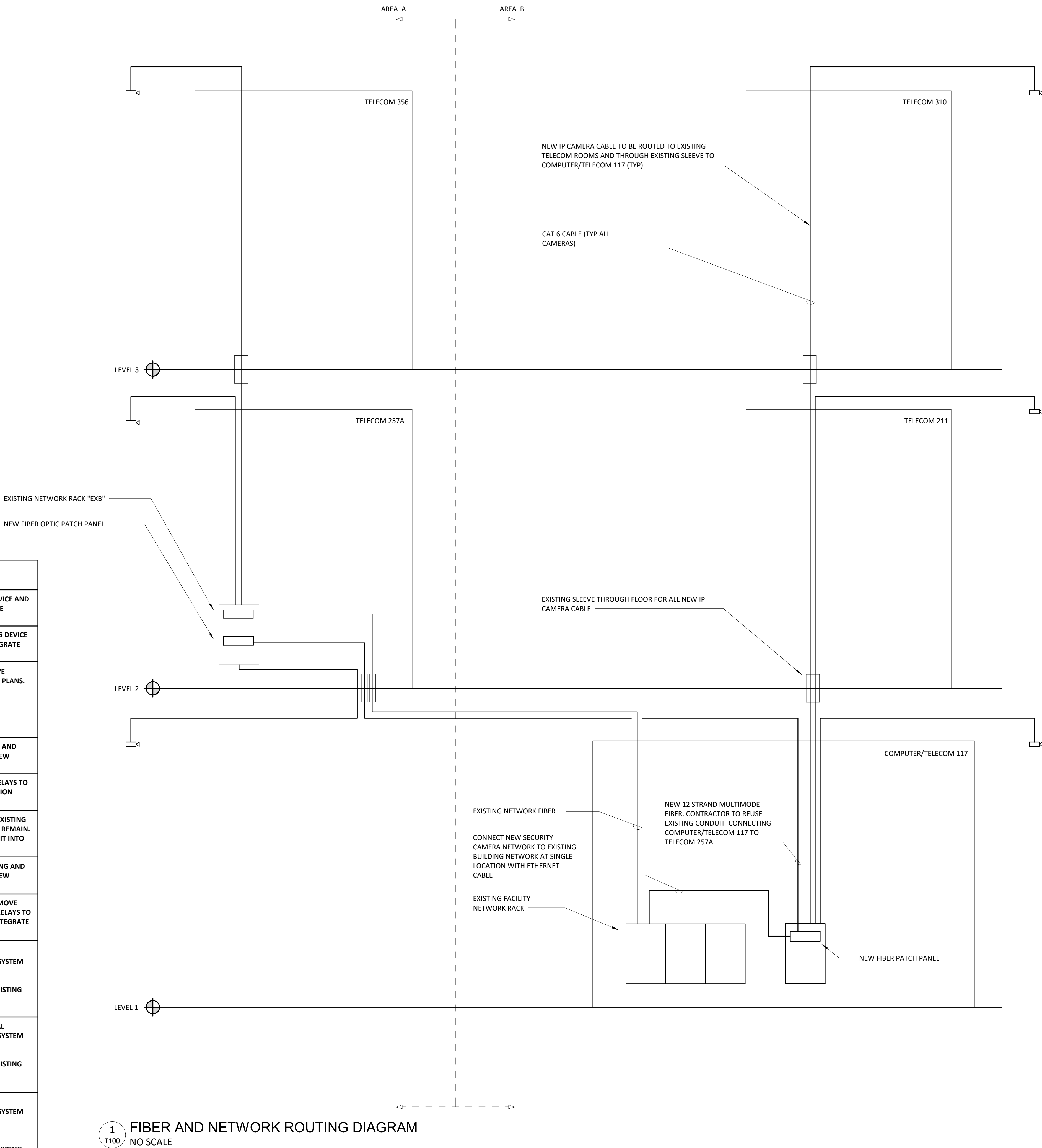

1 T100 FIBER AND NETWORK ROUTING DIAGRAM  
NO SCALE

COURTHOUSE - TECHNOLOGY NOTES AND SYMBOLS

CHAMPAIGN COUNTY COURTHOUSE & JUVENILE DETENTION CENTER- SECURITY CAMERA AND MASTER CONTROL SYSTEMS UPGRADE

CHAMPAIGN COUNTY  
101 E MAIN STREET, URBANA, IL 61801

SEA

DESIGNED BY	LEWIS
DATE	12/4/2019
BID DOCUMENTS	
PROJECT	GHR # 7257

SHEET:

T100

12/3/2019 4:25:56 PM  
C:\Users\dschultz\Documents\7257 - CC COURTHOUSE CAMERAS & MCS REPLACEMENT - MEP19 - CENTRAL - Dschultz.rvt  
GHR # 7257 - CHAMPAIGN COUNTY COURTHOUSE & JUVENILE DETENTION CENTER SECURITY CAMERA AND MASTER CONTROL SYSTEMS UPGRADE



BASEMENT FLOOR PLAN - SYSTEMS - AREA B - DEMO

SCALE: 1/8" = 1'-0"

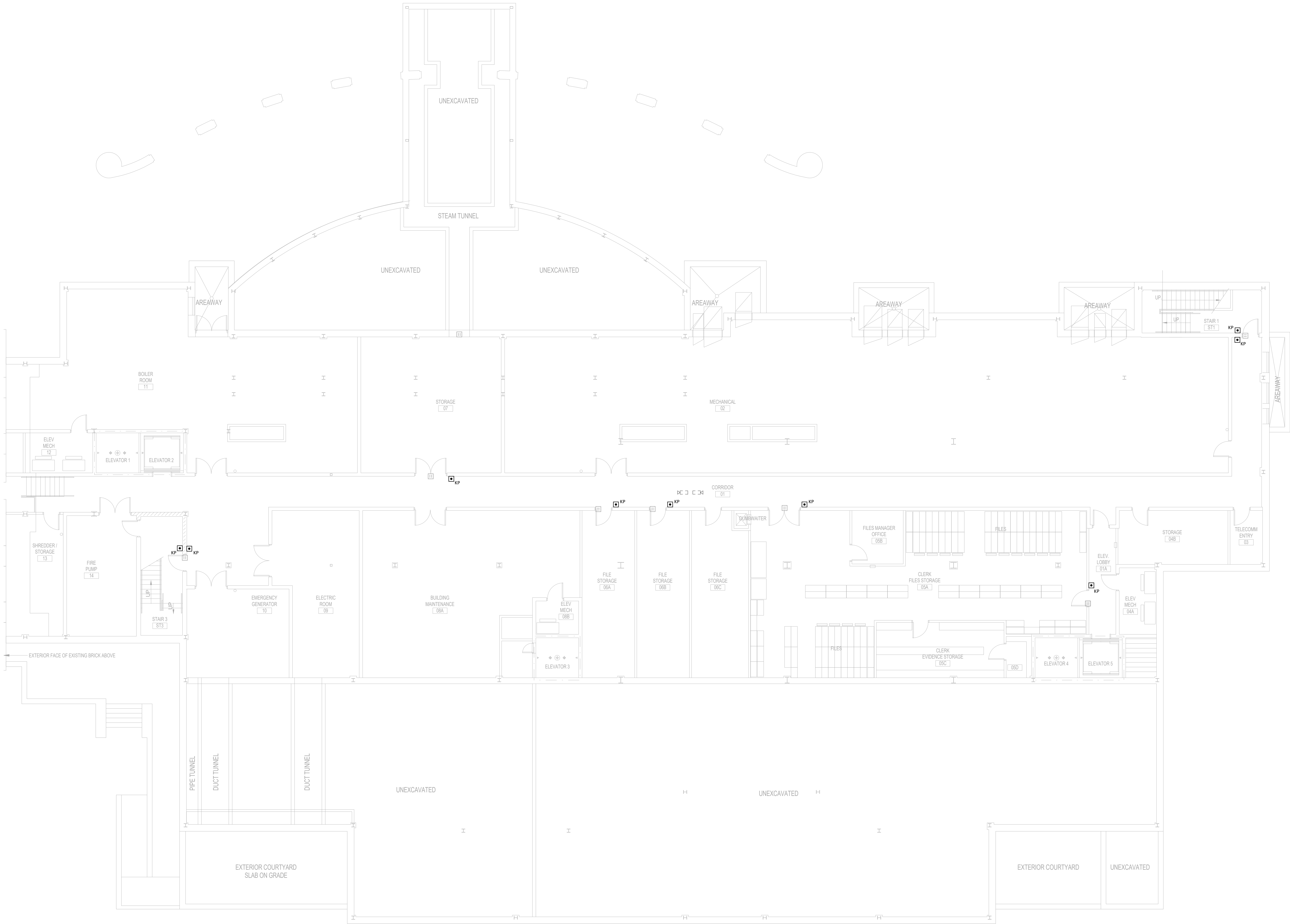
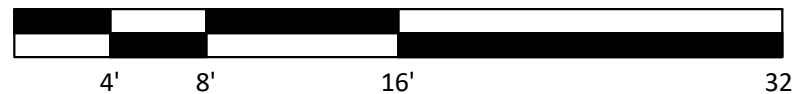

DATE	NO.	DESCRIPTION

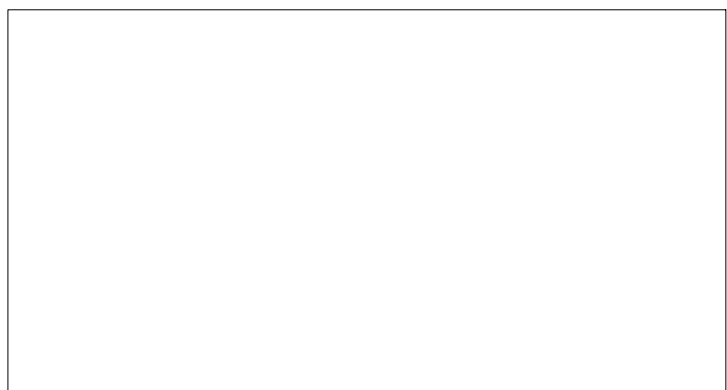

COURTHOUSE - PARTIAL BASEMENT DEMO PLAN - AREA B - TECHNOLOGY
CHAMPAIGN COUNTY COURTHOUSE & JUVENILE DETENTION CENTER- SECURITY CAMERA AND MASTER CONTROL SYSTEMS UPGRADE
CHAMPAIGN COUNTY 101 E MAIN STREET, URBANA, IL 61801

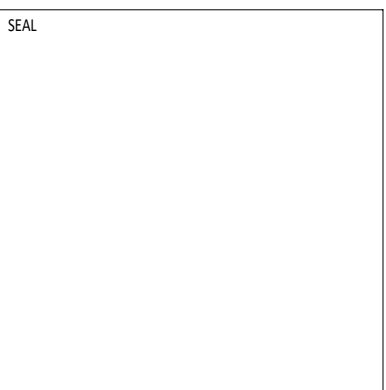

DRAWN: DES	APPROVED: LEM
DATE: 12/4/2019	
BID DOCUMENTS	
PROJECT: GHR # 7257	

SHEET:
TD102.1



KEYED NOTES - TECHNOLOGY

① EXISTING CAMERA AND ASSOCIATED WIRING TO BE DISCONNECTED AND REMOVED. EXISTING BUILDING PENETRATION TO BE SEALED FOLLOWING REMOVAL.

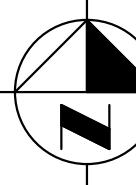
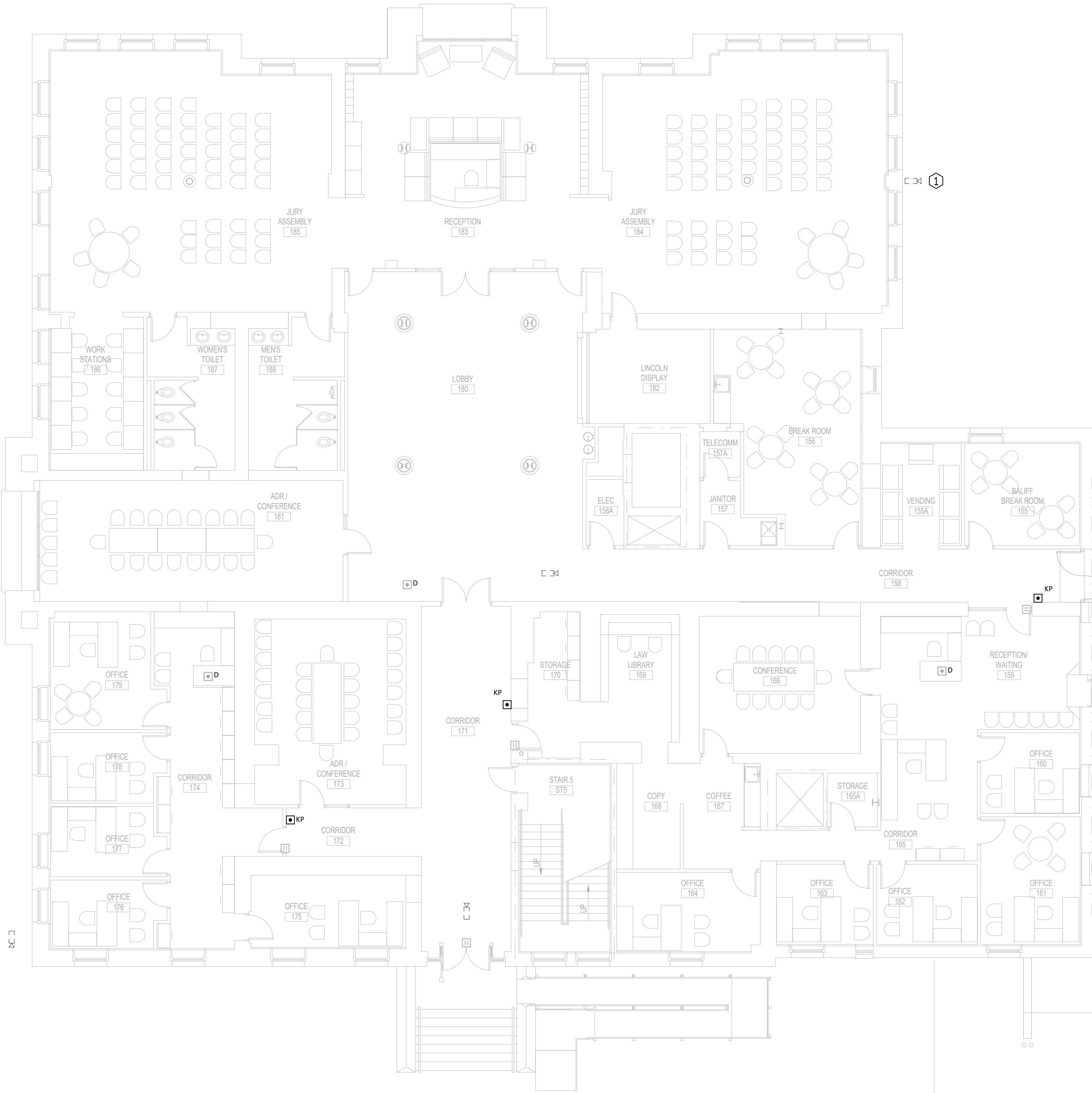

FIRST FLOOR PLAN - SYSTEMS - AREA A - DEMO

SCALE: 1/8" = 1'-0"



12/3/2019 4:27:24 PM  
C:\Users\dschultz\Documents\7257 - CC COURTHOUSE CAMERAS & MCS REPLACEMENT - MEP19 - CENTRAL Dischultz.rvt  
GHR # 7257 - CHAMPAIGN COUNTY COURTHOUSE & JUVENILE DETENTION CENTER SECURITY CAMERA AND MASTER CONTROL SYSTEMS UPGRADE

DATE	NO.	DESCRIPTION

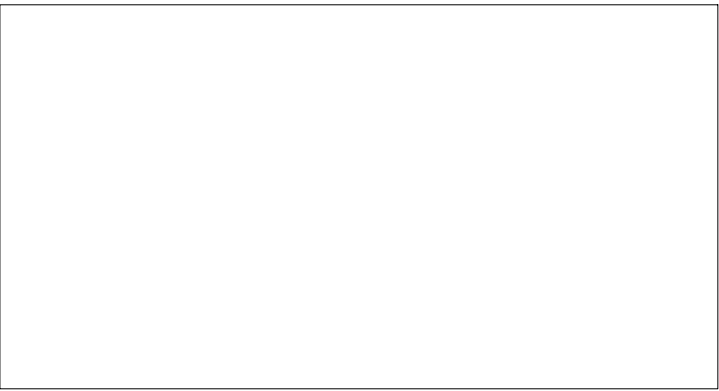

COURTHOUSE - PARTIAL FIRST FLOOR DEMO PLAN - AREA A - TECHNOLOGY
CHAMPAIGN COUNTY COURTHOUSE & JUVENILE DETENTION CENTER- SECURITY CAMERA AND MASTER CONTROL SYSTEMS UPGRADE
CHAMPAIGN COUNTY 101 E MAIN STREET, URBANA, IL 61801

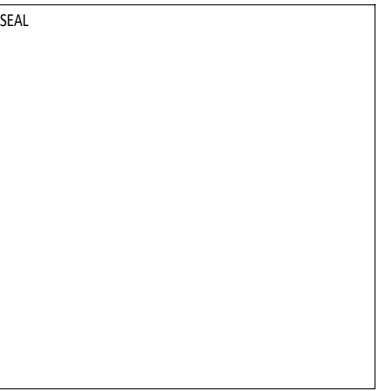

DRAWN: DES	APPROVED: LEM
DATE: 12/4/2019	
BID DOCUMENTS	
PROJECT: GHR # 7257	

SHEET:
TD111.1

THE ORIGINAL OF THIS DRAWING IS 30"x42". IF THIS COPY IS ANY OTHER SIZE, IT HAS EITHER BEEN REDUCED OR ENLARGED. TAKE APPROPRIATE PRECAUTIONS ACCORDINGLY.

12/3/2019 4:26:06 PM  
C:\Users\dschultz\Documents\7257 - CC COURTHOUSE CAMERAS & MCS REPLACEMENT - MEP19 - CENTRAL - Dschultz.rvt  
GHR # 7257 - CHAMPAIGN COUNTY COURTHOUSE & JUVENILE DETENTION CENTER SECURITY CAMERA AND MASTER CONTROL SYSTEMS UPGRADE

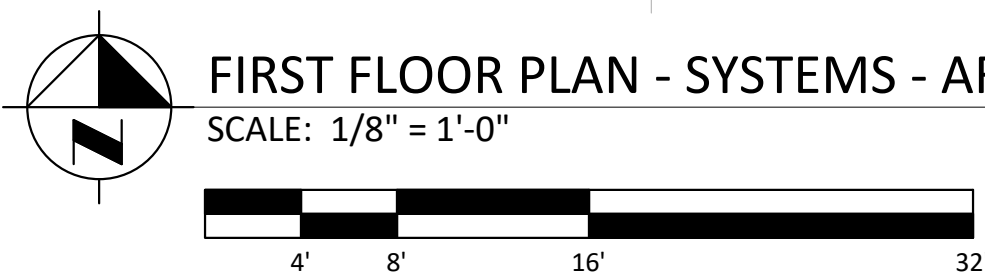

FIRST FLOOR PLAN - SYSTEMS - AREA B - DEMO

SCALE: 1/8" = 1'-0"

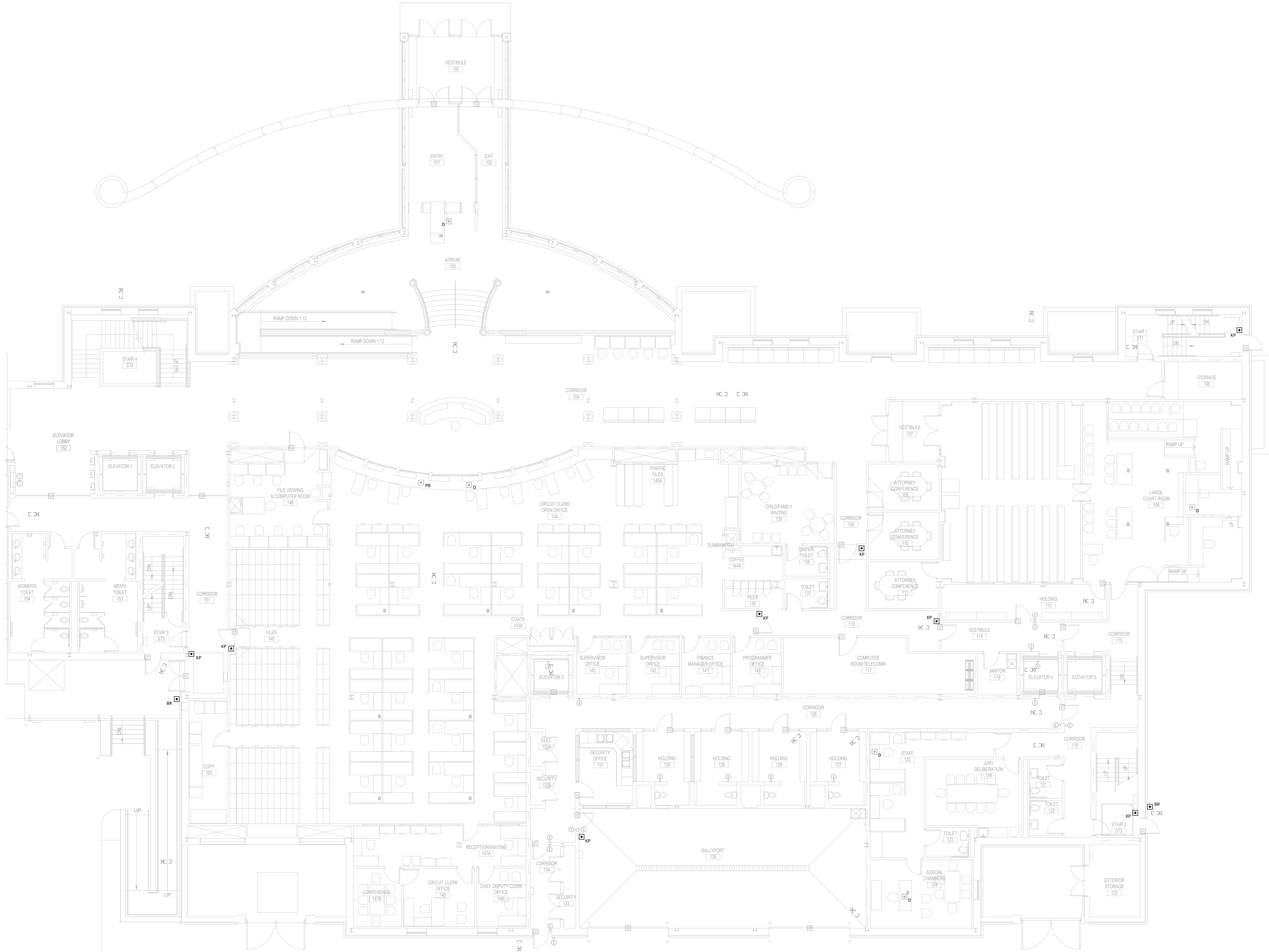

DATE	NO.	DESCRIPTION

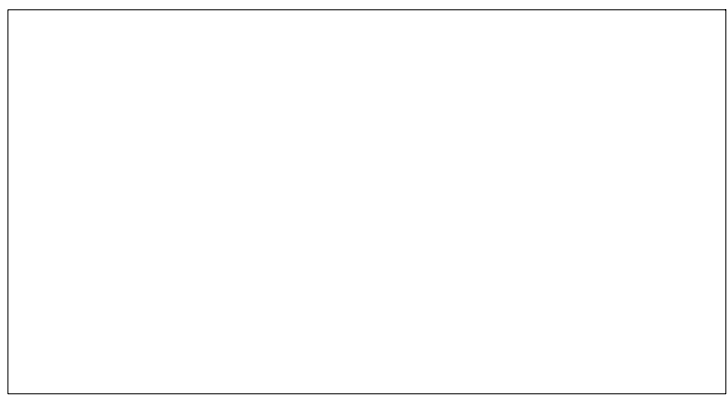

COURTHOUSE - PARTIAL FIRST FLOOR DEMO PLAN - AREA B - TECHNOLOGY	
CHAMPAIGN COUNTY COURTHOUSE & JUVENILE DETENTION CENTER- SECURITY CAMERA AND MASTER CONTROL SYSTEMS UPGRADE	
CHAMPAIGN COUNTY 101 E MAIN STREET, URBANA, IL 61801	

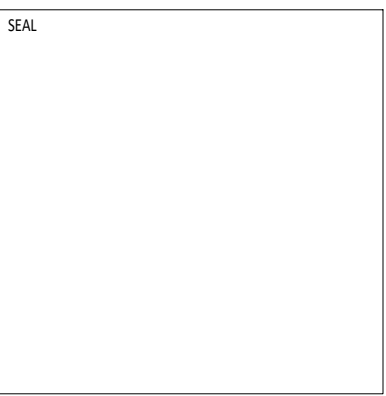

DRAWN:	DES	APPROVED:	LEM
DATE:	12/4/2019		
PROJECT:	BID DOCUMENTS		
	GHR # 7257		

SHEET:	TD112.1
--------	---------

THE ORIGINAL OF THIS DRAWING IS 30"x42". IF THIS COPY IS ANY OTHER SIZE, IT HAS EITHER BEEN REDUCED OR ENLARGED. TAKE APPROPRIATE PRECAUTIONS ACCORDINGLY.

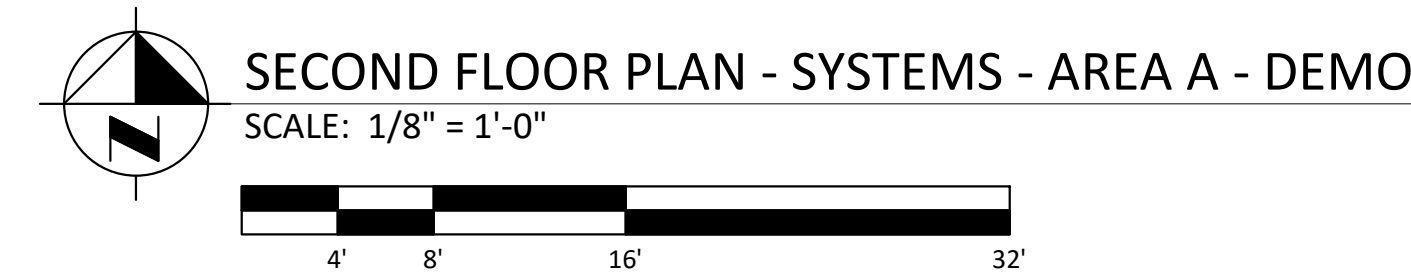

	DRAWN:	DES	APPROVED:	LEM
	DATE:	12/4/2019		
	BID DOCUMENTS			
	PROJECT:	GHR # 7257		

SHEET:

# TD121.1

12/3/2019 4:26:18 PM  
C:\Users\dschultz\Documents\7257 - CC COURTHOUSE CAMERAS & MCS REPLACEMENT - MEP19 - CENTRAL - DSchultz.dwg  
GHR # 7257 - CHAMPAIGN COUNTY COURTHOUSE & JUVENILE DETENTION CENTER SECURITY CAMERA AND MASTER CONTROL SYSTEMS UPGRADE

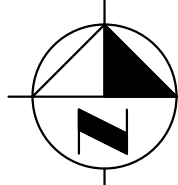
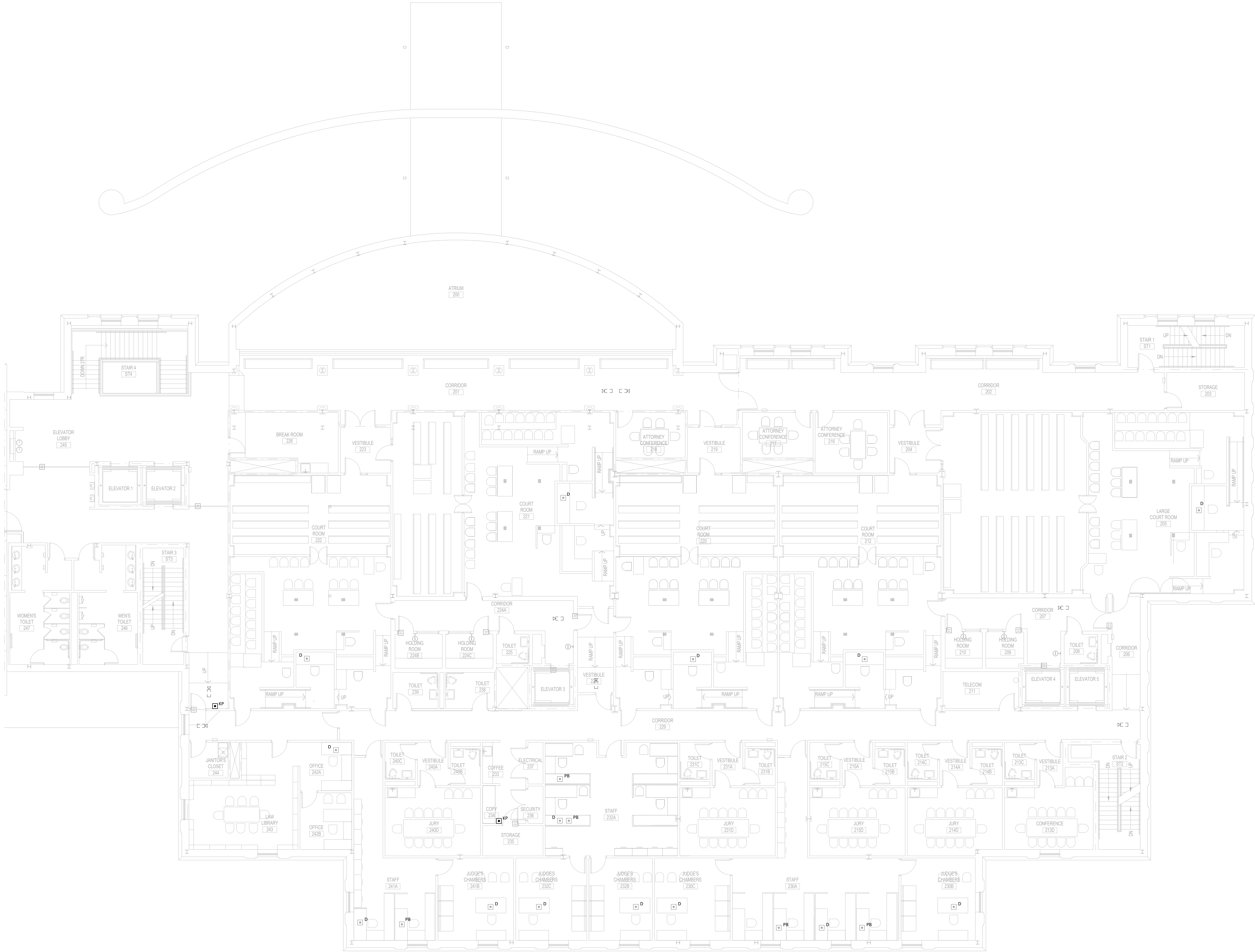

SECOND FLOOR PLAN - SYSTEMS - AREA B - DEMO

SCALE: 1/8" = 1'-0"



DATE	NO.	DESCRIPTION

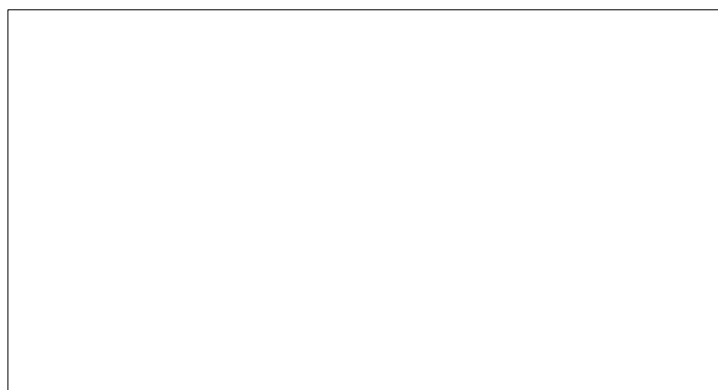

COURTHOUSE - PARTIAL SECOND DEMO PLAN - AREA B - TECHNOLOGY	
CHAMPAIGN COUNTY COURTHOUSE & JUVENILE DETENTION CENTER- SECURITY CAMERA AND MASTER CONTROL SYSTEMS UPGRADE	
CHAMPAIGN COUNTY 101 E MAIN STREET, URBANA, IL 61801	

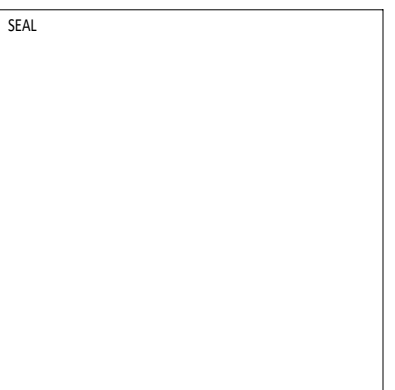

DRAWN:	DES	APPROVED:	LEM
DATE:	12/4/2019		
PROJECT:	BID DOCUMENTS		
	GHR # 7257		

SHEET:
TD122.1

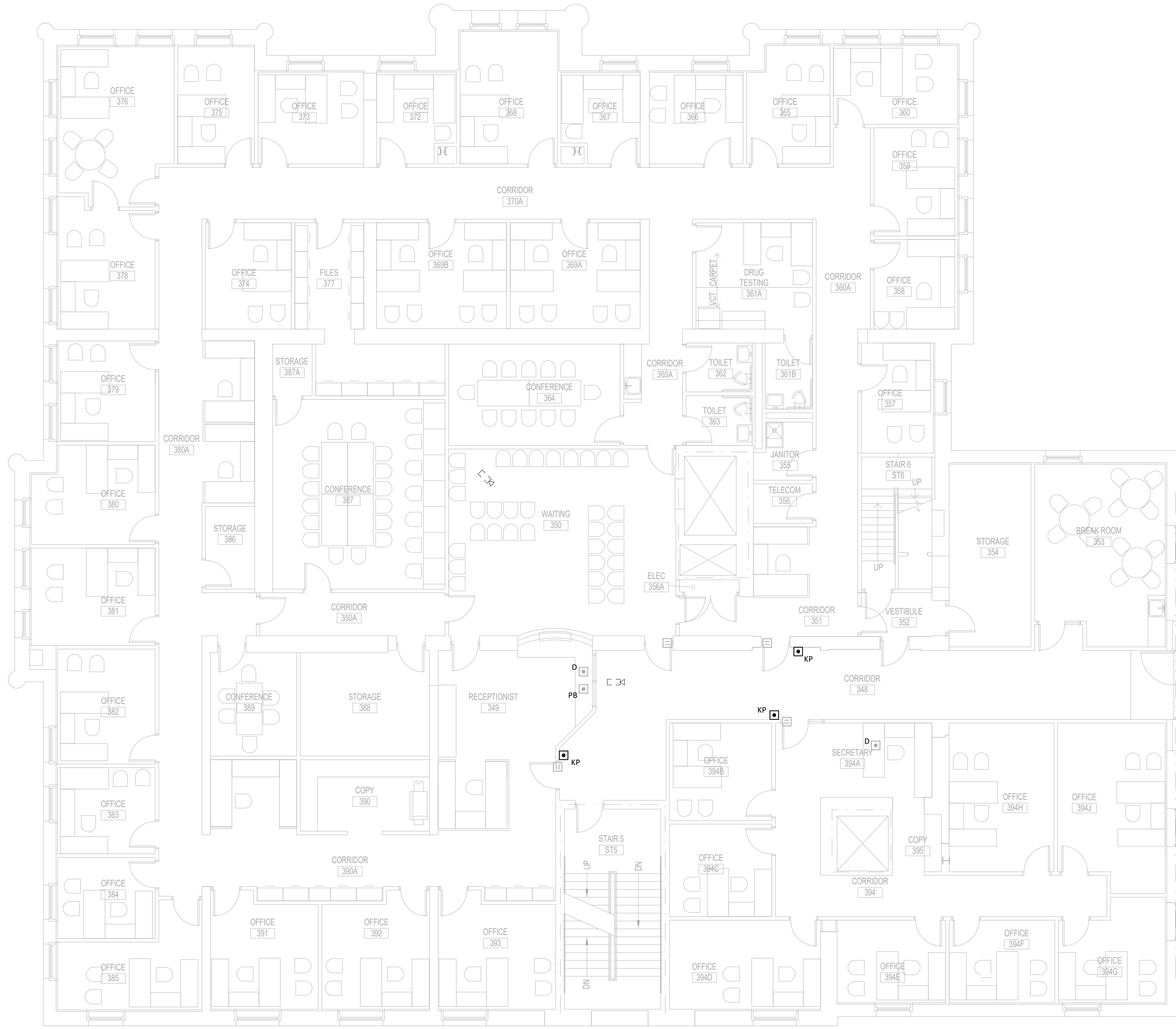

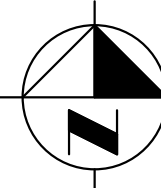
 **THIRD FLOOR PLAN - SYSTEMS - AREA A - DEMO**  
SCALE: 1/8" = 1'-0"



12/3/2019 4:26:25 PM  
C:\Users\dschultz\Documents\7257 - CC COURTHOUSE CAMERAS & MICS REPAIR/REPLACEMENT - MEPI19 - CENTRAL - Dschultz.rvt  
GHR # 7257 - CHAMPAIGN COUNTY COURTHOUSE & JUVENILE DETENTION CENTER SECURITY CAMERA AND MASTER CONTROL SYSTEMS UPGRADE

DATE	NO.	DESCRIPTION

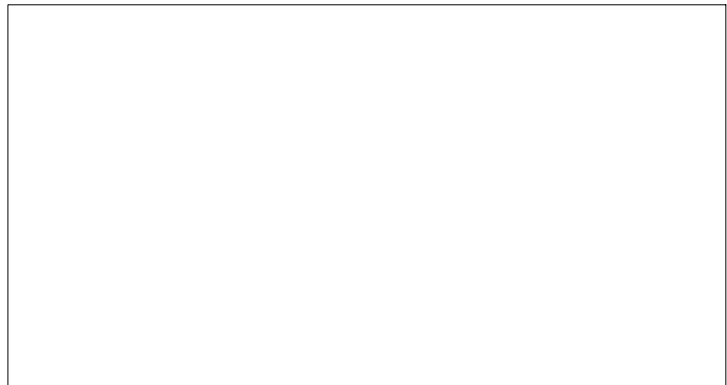

**COURTHOUSE - PARTIAL THIRD FLOOR DEMO PLAN - AREA A - TECHNOLOGY**

**CHAMPAIGN COUNTY COURTHOUSE & JUVENILE DETENTION CENTER- SECURITY CAMERA AND MASTER CONTROL SYSTEMS UPGRADE**

CHAMPAIGN COUNTY  
101 E MAIN STREET, URBANA, IL 61801

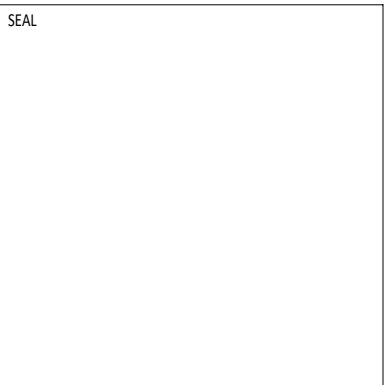

DESIGNED BY	LEM
DATE	12/4/2019
PROJECT	BID DOCUMENTS
PROJECT	GHR # 7257

SHEET:
<b>TD131.1</b>

THE ORIGINAL OF THIS DRAWING IS 30"x42". IF THIS COPY IS ANY OTHER SIZE, IT HAS EITHER BEEN REDUCED OR ENLARGED. TAKE APPROPRIATE PRECAUTIONS ACCORDINGLY.



12/3/2019 4:26:32 PM  
C:\Users\dschultz\Documents\7257 - CC COURTHOUSE CAMERAS & MCS REPLACEMENT - MEP19 - CENTRAL - Dschultz.rvt  
GHR # 7257 - CHAMPAIGN COUNTY COURTHOUSE & JUVENILE DETENTION CENTER SECURITY CAMERA AND MASTER CONTROL SYSTEMS UPGRADE

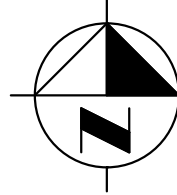

THIRD FLOOR PLAN - SYSTEMS - AREA B - DEMO

SCALE: 1/8" = 1'-0"

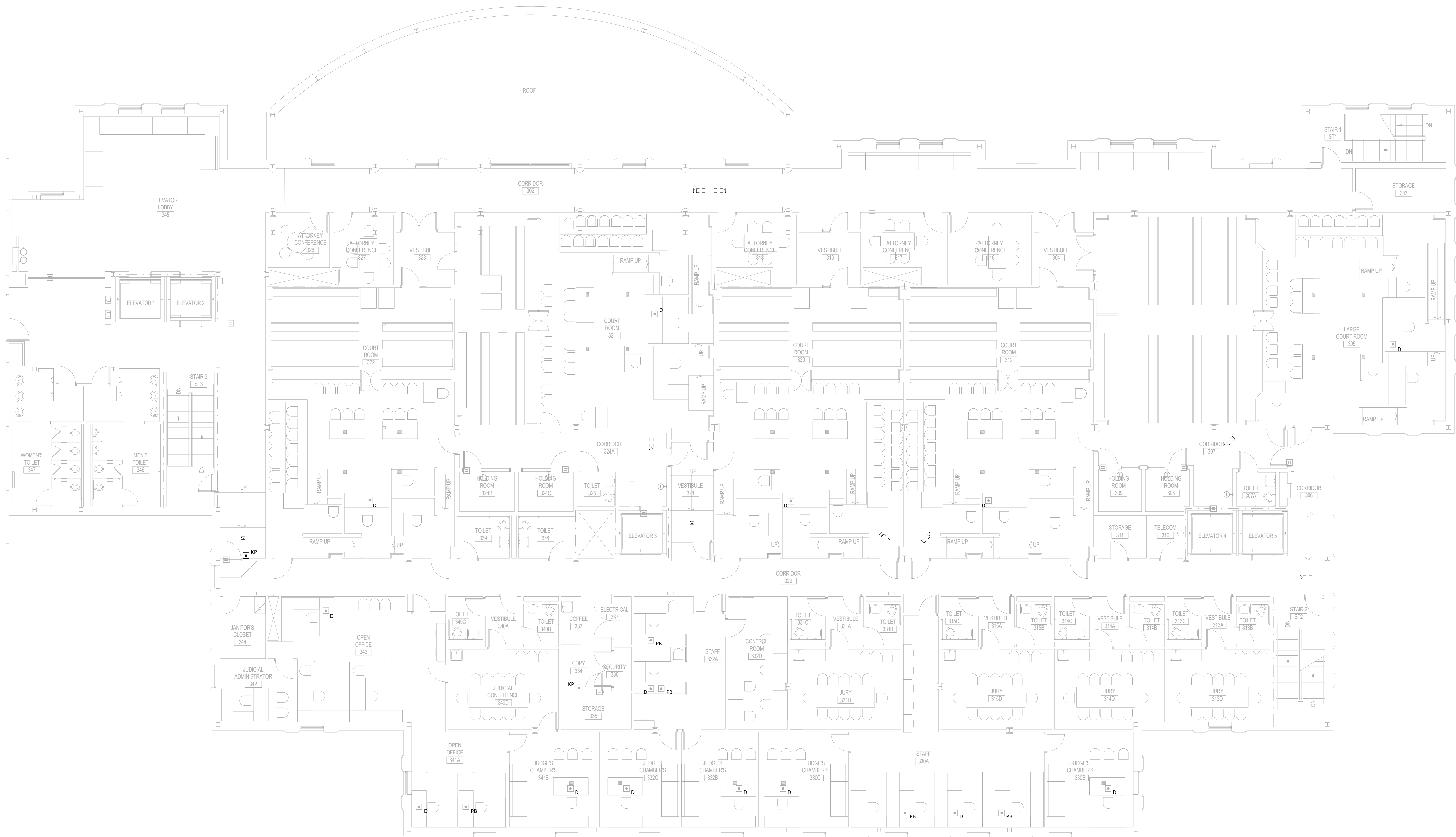

DATE	NO.	DESCRIPTION

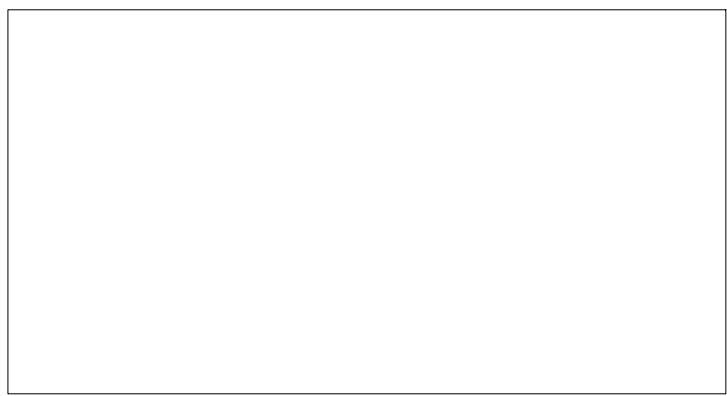

COURTHOUSE - PARTIAL THIRD FLOOR DEMO PLAN - AREA B - TECHNOLOGY
CHAMPAIGN COUNTY COURTHOUSE & JUVENILE DETENTION CENTER- SECURITY CAMERA AND MASTER CONTROL SYSTEMS UPGRADE
CHAMPAIGN COUNTY 101 E MAIN STREET, URBANA, IL 61801

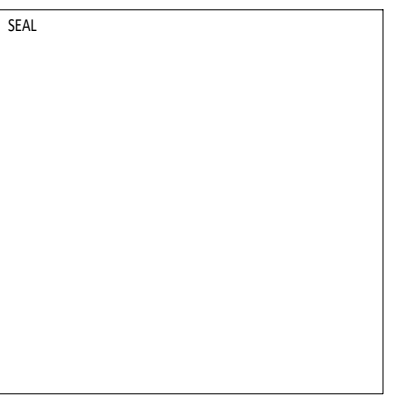

DRAWN: DES	APPROVED: LEM
DATE: 12/4/2019	
PROJECT: BID DOCUMENTS	
	GHR # 7257

SHEET: TD132.1
----------------

THE ORIGINAL OF THIS DRAWING IS 30"x42". IF THIS COPY IS ANY OTHER SIZE, IT HAS EITHER BEEN REDUCED OR ENLARGED. TAKE APPROPRIATE PRECAUTIONS ACCORDINGLY.

KEYED NOTES - TECHNOLOGY

- ① IP CAMERA ROUTED THROUGH STEAM TUNNEL TO BE 3/4" EMT CONDUIT.
- ② CORE DRILL THROUGH BUILDING FOUNDATION FOR ROUTING IP CAMERA WIRING BENEATH GRADE TO IP CAMERA LOCATIONS SHOWN ON T112.1. SEAL EXTERIOR BUILDING FOUNDATION WITH MECHANICAL LINK SEAL.
- ③ ROUTE CONDUIT THROUGH AREAWAY AS SHOWN.

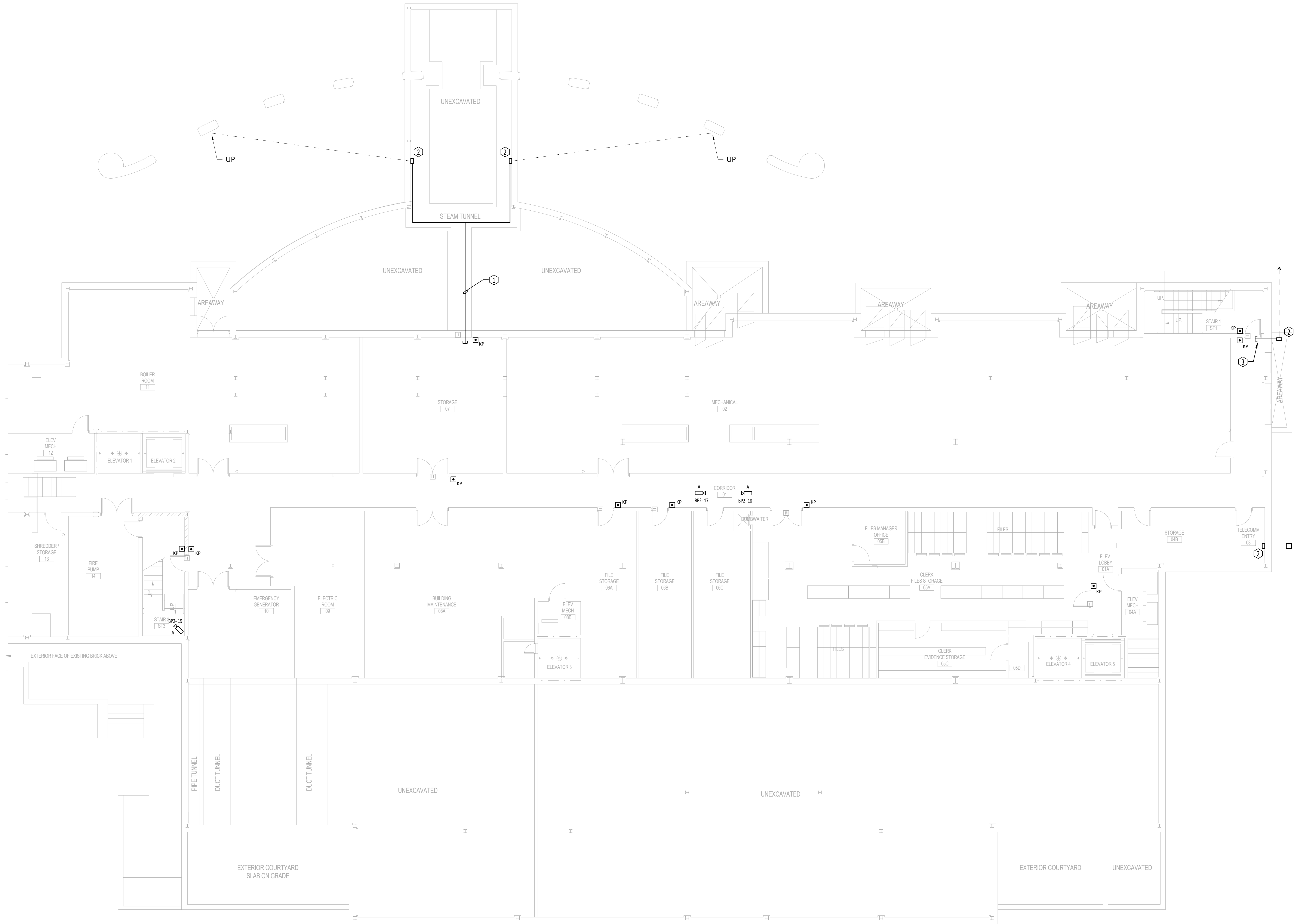

BASEMENT FLOOR PLAN - SYSTEMS - AREA B  
SCALE: 1/8" = 1'-0"

12/3/2019 4:25:08 PM  
C:\Users\dschultz\Documents\7257 - CC COURTHOUSE CAMERAS & MCS REPLACEMENT - MEP19 - CENTRAL - D'schultz.rvt  
GHR # 7257 - CHAMPAIGN COUNTY COURTHOUSE & JUVENILE DETENTION CENTER SECURITY CAMERA AND MASTER CONTROL SYSTEMS UPGRADE

DATE	NO.	DESCRIPTION

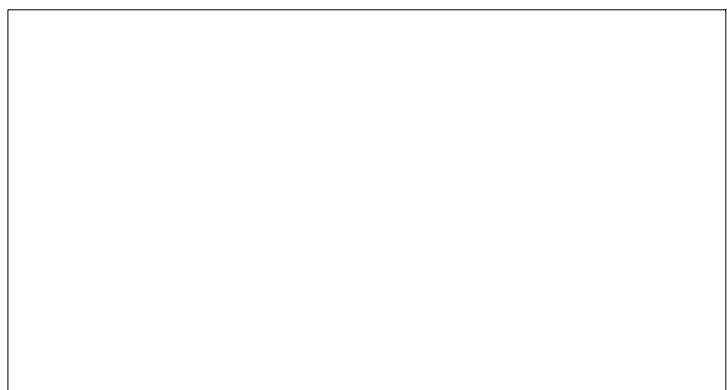

COURTHOUSE - PARTIAL BASEMENT FLOORPLAN - AREA B - TECHNOLOGY

CHAMPAIGN COUNTY COURTHOUSE & JUVENILE DETENTION CENTER- SECURITY CAMERA AND MASTER CONTROL SYSTEMS UPGRADE

CHAMPAIGN COUNTY  
101 E MAIN STREET, URBANA, IL 61801

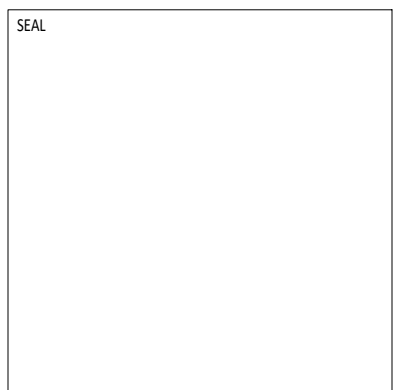

DRAWN: DES	APPROVED: LEM
DATE: 12/4/2019	
BID DOCUMENTS	
PROJECT: GHR # 7257	

SHEET: T102.1

1. PROVIDE WEATHERPROOF JUNCTION BOX FOR NEW SURFACE MOUNTED CAMERA. DRILL THROUGH EXISTING BUILDING EXTERIOR WALL FOR CABLE ROUTING AND SEAL.

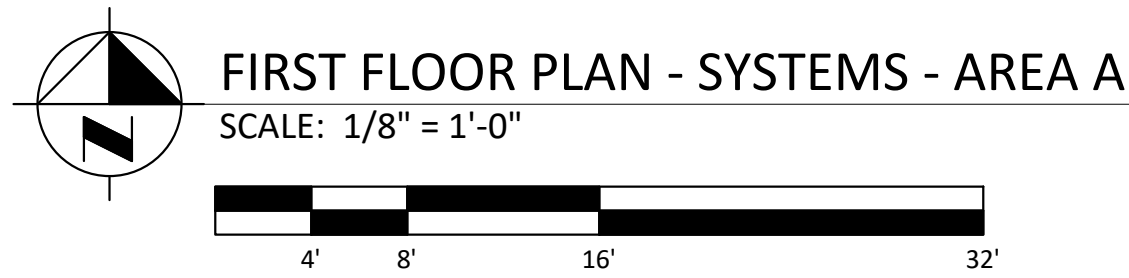
[illegible]

## CHAMPAIGN COUNTY COURTHOUSE & JUVENILE DETENTION CENTER- SECURITY CAMERA AND MASTER CONTROL SYSTEMS UPGRADE

CHAMPAIGN COUNTY  
101 E MAIN STREET, URBANA, IL 61801

SEA:	DRAWN:	DES	APPROVED:	LEM	SHEET:       <b>T111.1</b>
	DATE:			12/4/2019	
	BID DOCUMENTS				
	PROJECT:	GHR # 7257			

THE ORIGINAL OF THIS DRAWING IS 30"x42" . IF THIS COPY IS ANY OTHER SIZE, IT HAS EITHER BEEN REDUCED OR ENLARGED. TAKE APPROPRIATE PRECAUTIONS ACCORDINGLY.

12/3/2019 4:25:20 PM  
C:\Users\dschultz\Documents\7257 - CC COURTHOUSE CAMERAS & MCS REPLACEMENT - MEP19 - CENTRAL - D'schultz.rvt  
GHR # 7257 - CHAMPAIGN COUNTY COURTHOUSE & JUVENILE DETENTION CENTER- SECURITY CAMERA AND MASTER CONTROL SYSTEMS UPGRADE

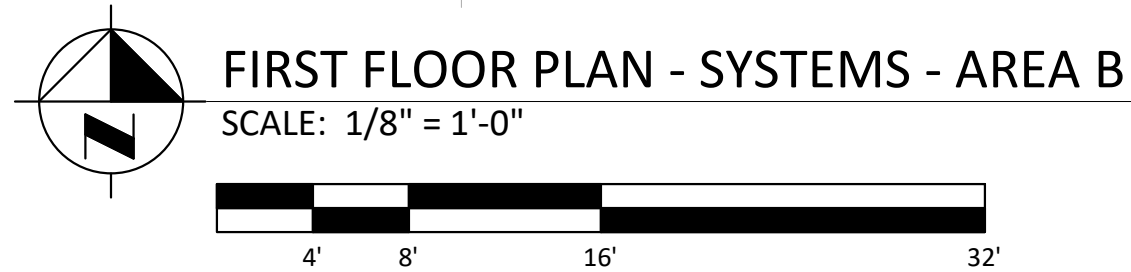

FIRST FLOOR PLAN - SYSTEMS - AREA B  
SCALE: 1/8" = 1'-0"

DATE	NO.	DESCRIPTION



COURTHOUSE - PARTIAL FIRST FLOOR FLOORPLAN - AREA B - TECHNOLOGY  
CHAMPAIGN COUNTY COURTHOUSE & JUVENILE DETENTION CENTER- SECURITY CAMERA AND MASTER CONTROL SYSTEMS UPGRADE  
CHAMPAIGN COUNTY  
101 E MAIN STREET, URBANA, IL 61801

KEYED NOTES - TECHNOLOGY

- EXISTING NETWORK RACKS "EX-B". SEE 1/T100 FOR WIRING INSTRUCTIONS.
- PROVIDE WEATHERPROOF JUNCTION BOX FOR NEW SURFACE MOUNTED CAMERA. DRILL THROUGH EXISTING BUILDING EXTERIOR WALL FOR CABLE ROUTING AND SEAL.
- PLUG NETWORK RACK POWER SUPPLY INTO ADJACENT EMERGENCY RECEPTACLE.
- 1" BURIED PVC CONDUIT FOR IP CAMERA WIRING. STUB-UP TO ABOVE GRADE TO BE RIGID CONDUIT.
- PROVIDE WEATHER PROOF BOX WITH FLEXIBLE WHIP TO IP CAMERA.
- MOUNT IP CAMERA ON ARM MOUNT ON EXISTING LIGHTING POLE.
- DIRECTIONAL BONE CONDUIT BENEATH EXISTING ASPHALT PARKING LOT.
- 12"x12" GRADE BOX WITH (1) 1" CONDUIT STUBBED INTO BUILDING AND (2) 1" CONDUITS ROUTED TO LIGHTING POLES FOR NEW IP CAMERAS.
- PROVIDE 4"x4"x6" TALL STAINLESS STEEL DEVICE PEDESTAL ON 12" DIAMETER 42" DEEP CONCRETE FOUNDATION FOR NEW INTERCOM STATION. ROUTE 1" PVC CONDUIT TO EXTERIOR FACE OF BUILDING AND STUB UP TO 18" ABOVE GRADE WITH RIGID CONDUIT AND PENETRATE BUILDING.
- ROUTE 1" PVC CONDUIT BENEATH GRADE TO FREESTANDING SHELTER. INSTALL IP CAMERA INSIDE SHELTER.
- RECONNECT AND PROGRAM NEW MASTER CONTROL SYSTEM SUCH ELEVATOR CONTROLS ARE REESTABLISHED.
- INSTALL (2) RACK MOUNTED NETWORK VIDEO RECORDERS WITH A MINIMUM COMBINED STORAGE NO LESS THAN 142 TERABYTES AND CAN SUPPORT 756 MB/s TOTAL BANDWIDTH.
- CONTRACTOR TO SIZE AND INSTALL NEW UPS SUCH THAT UPS CAN SUPPORT THE TOTAL CONNECTED LOAD FOR ALL DEVICES AND KEEP RACK FUNCTIONAL FOR AT MINIMUM 10 MINUTES.

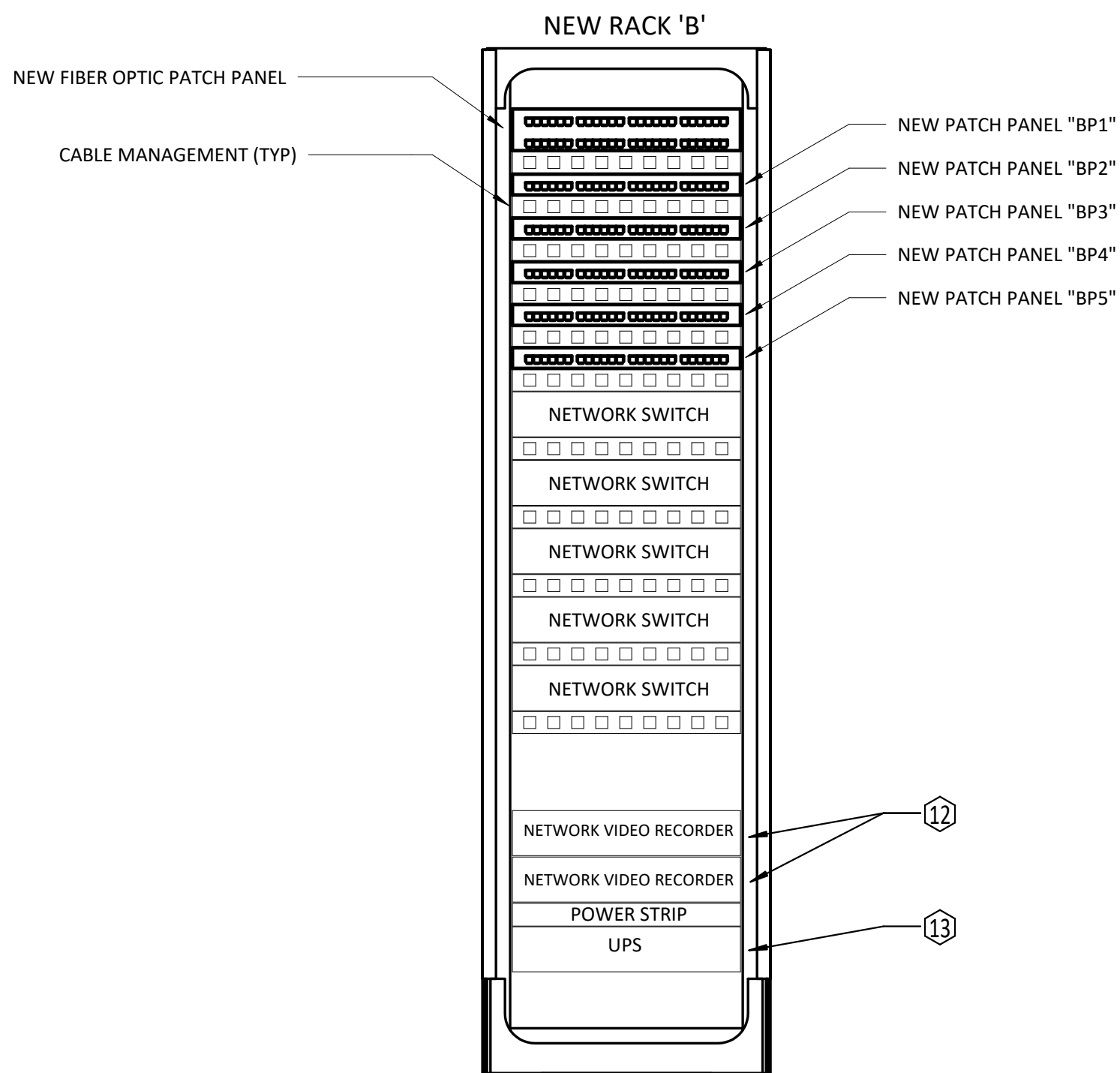

RACK "B" ELEVATION  
NO SCALE

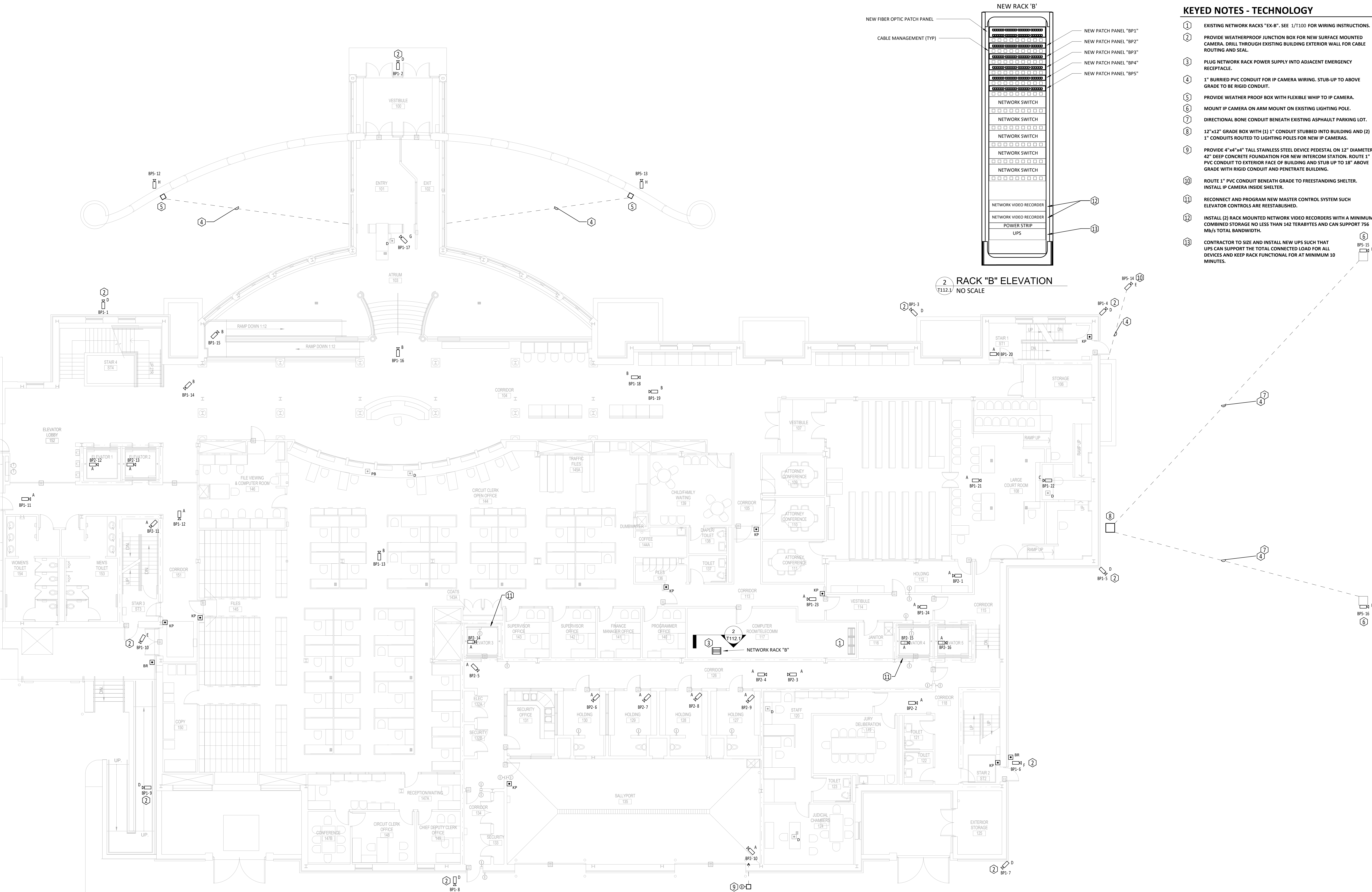



KEYED NOTES - TECHNOLOGY

- 1 PLUG NEW NETWORK RACK POWER SUPPLY INTO ADJACENT EMERGENCY RECEPTACLE.
- 2 CONTRACTOR TO SIZE AND INSTALL NEW UPS SUCH THAT UPS CAN SUPPORT THE TOTAL CONNECTED LOAD FOR ALL DEVICES AND KEEP RACK FUNCTIONAL FOR AT MINIMUM 10 MINUTES.



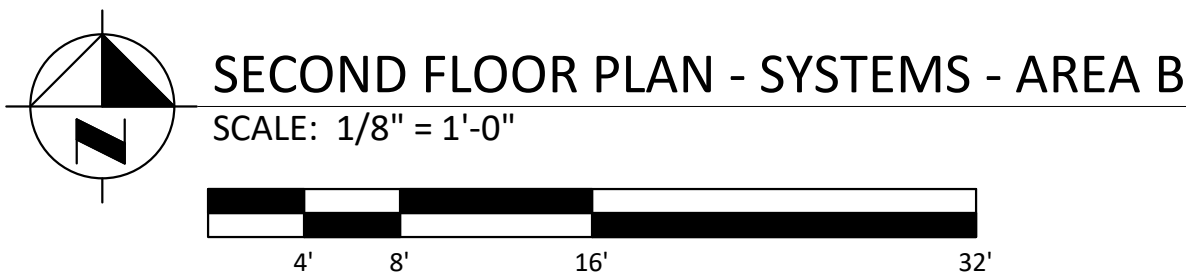

**GHR** ENGINEERS AND ASSOCIATES, INC.  
Mechanical & Electrical Consulting Engineers

CHAMPAIGN COUNTY  
101 E MAIN STREET, URBANA, IL 61801

THE ORIGINAL OF THIS DRAWING IS 30"x42". IF THIS COPY IS ANY OTHER SIZE, IT HAS EITHER BEEN REDUCED OR ENLARGED. TAKE APPROPRIATE PRECAUTIONS ACCORDINGLY

KEYED NOTES - TECHNOLOGY

- 1

FOR REFERENCE ONLY - DOOR WITH DOOR LOCK, WITH (2) KEYPADS (ONE ON EITHER SIDE) LOCATED AT TOP OF STAIRS. DOOR LOCK AND KEYPADS ARE WIRED TO AND CONTROLLED BY MASTER CONTROL SYSTEM.
- 2

FOR REFERENCE ONLY - DOOR WITH DOOR LOCK LOCATED AT TOP OF STAIR AND IS WIRED TO AND CONTROLLED BY MASTER CONTROL SYSTEM.

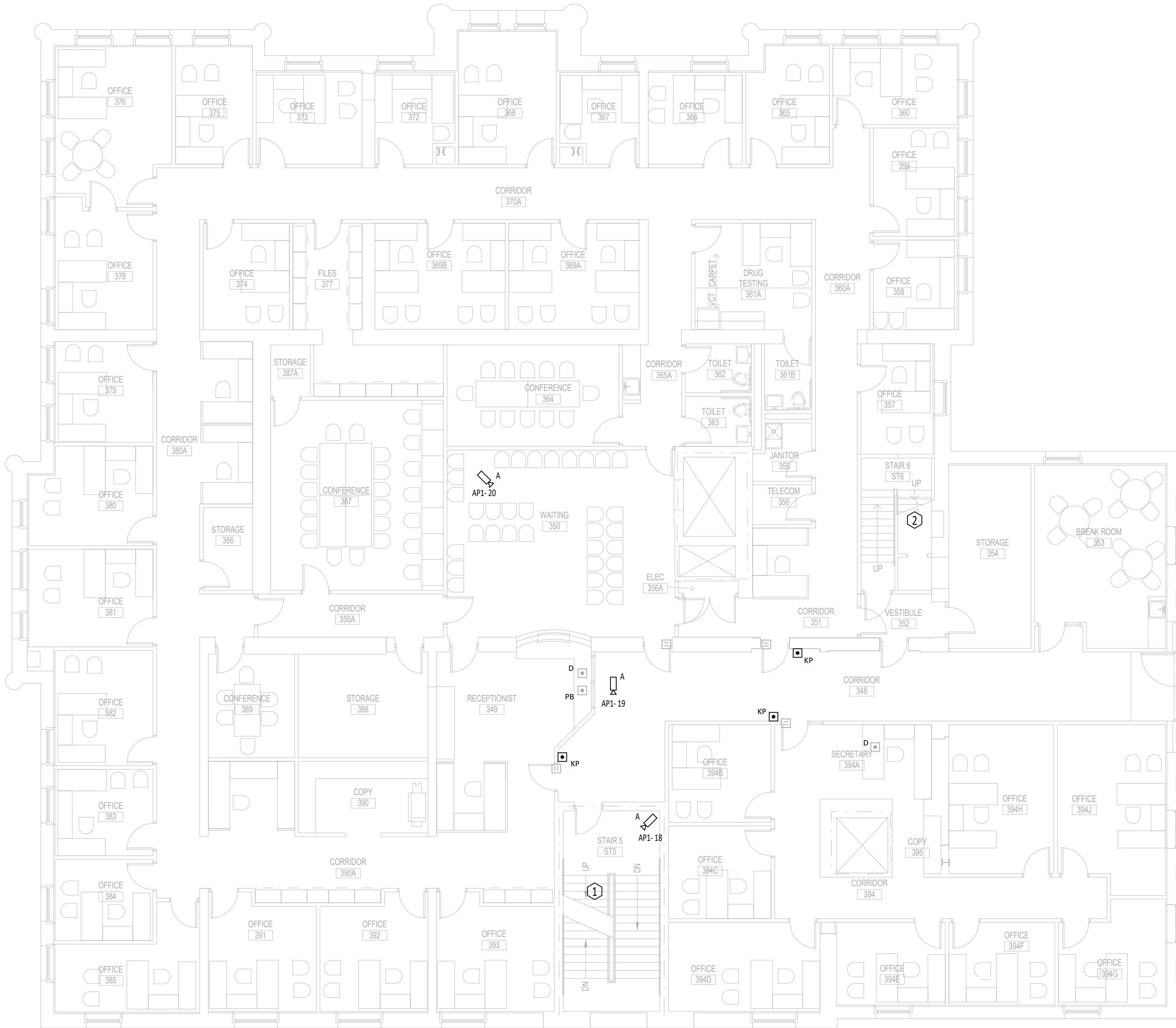

THIRD FLOOR PLAN - SYSTEMS - AREA A  
SCALE: 1/8" = 1'-0"

DATE	NO.	DESCRIPTION

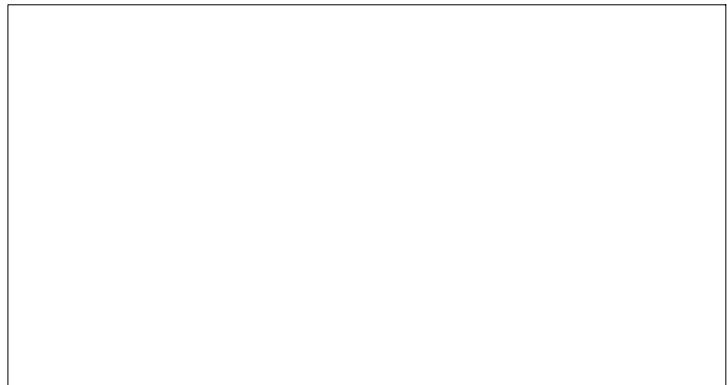

COURTHOUSE - PARTIAL THIRD FLOOR FLOORPLAN - AREA A - TECHNOLOGY

CHAMPAIGN COUNTY COURTHOUSE & JUVENILE DETENTION CENTER- SECURITY CAMERA AND MASTER CONTROL SYSTEMS UPGRADE

CHAMPAIGN COUNTY  
101 E MAIN STREET, URBANA, IL 61801

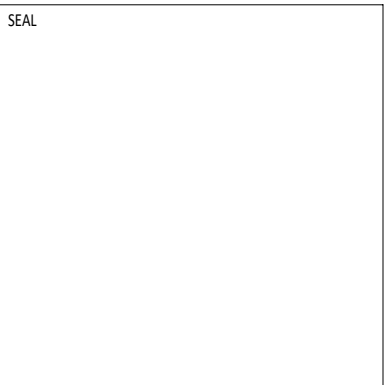

DRAWN: DES	APPROVED: LEM
DATE: 12/4/2019	
BID DOCUMENTS	
PROJECT: GHR # 7257	

SHEET:

T131.1

12/3/2019 4:25:49 PM  
C:\Users\dschultz\Documents\7257 - CC COURTHOUSE CAMERAS & MCS REPLACEMENT - MEPI19 - CENTRAL - Dischultz.rvt  
GHR # 7257 - CHAMPAIGN COUNTY COURTHOUSE & JUVENILE DETENTION CENTER SECURITY CAMERA AND MASTER CONTROL SYSTEMS UPGRADE

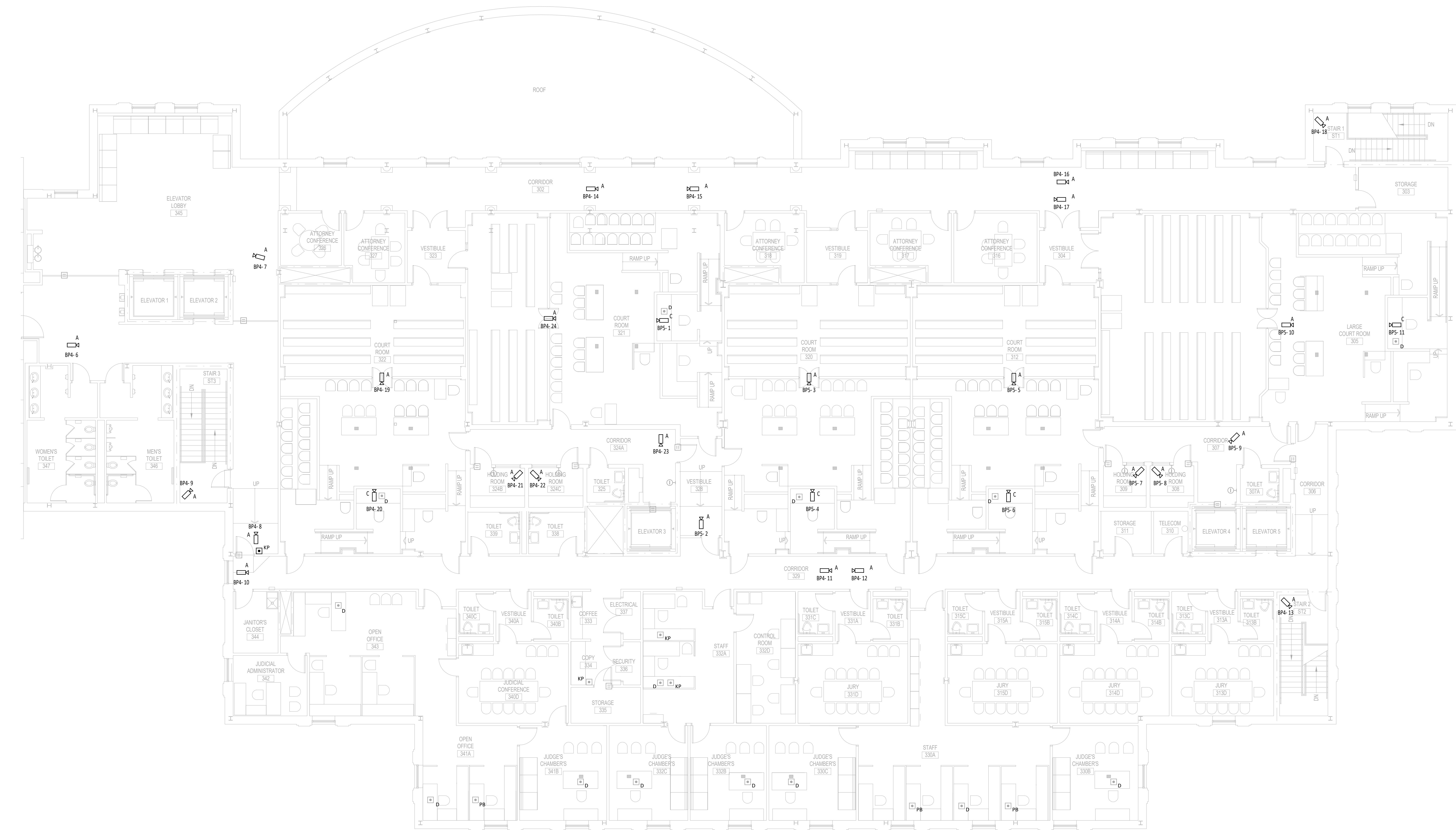

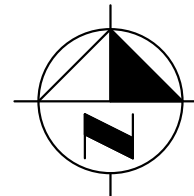
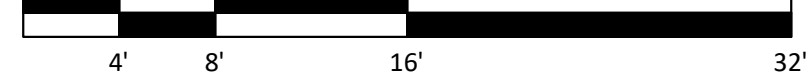
 **THIRD FLOOR PLAN - SYSTEMS - AREA B**  
SCALE: 1/8" = 1'-0"  

DATE	NO.	DESCRIPTION



**COURTHOUSE - PARTIAL THIRD FLOOR FLOORPLAN - AREA B - TECHNOLOGY**  
**CHAMPAIGN COUNTY COURTHOUSE & JUVENILE DETENTION CENTER- SECURITY CAMERA AND MASTER CONTROL SYSTEMS UPGRADE**  
CHAMPAIGN COUNTY  
101 E MAIN STREET, URBANA, IL 61801

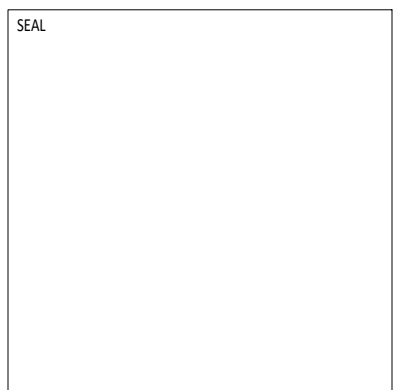

DESIGNED BY	APPROVED BY
LEM	LEM
DATE:	12/4/2019
PROJECT:	BID DOCUMENTS
	GHR # 7257

SHEET:
T132.1

THE ORIGINAL OF THIS DRAWING IS 30"x42". IF THIS COPY IS ANY OTHER SIZE, IT HAS EITHER BEEN REDUCED OR ENLARGED. TAKE APPROPRIATE PRECAUTIONS ACCORDINGLY.



GENERAL NOTES - TECHNOLOGY

1. ALL EXISTING CAMERAS ARE TO BE DISCONNECTED AND WIRING IS TO BE REMOVED BACK TO NETWORK RACK. EXISTING PATHWAYS AND MOUNTING TO BE UTILIZED AND REUSED AS POSSIBLE DURING FOR NEW CAMERA INSTALLATION.

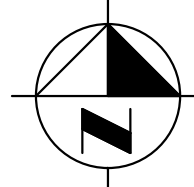
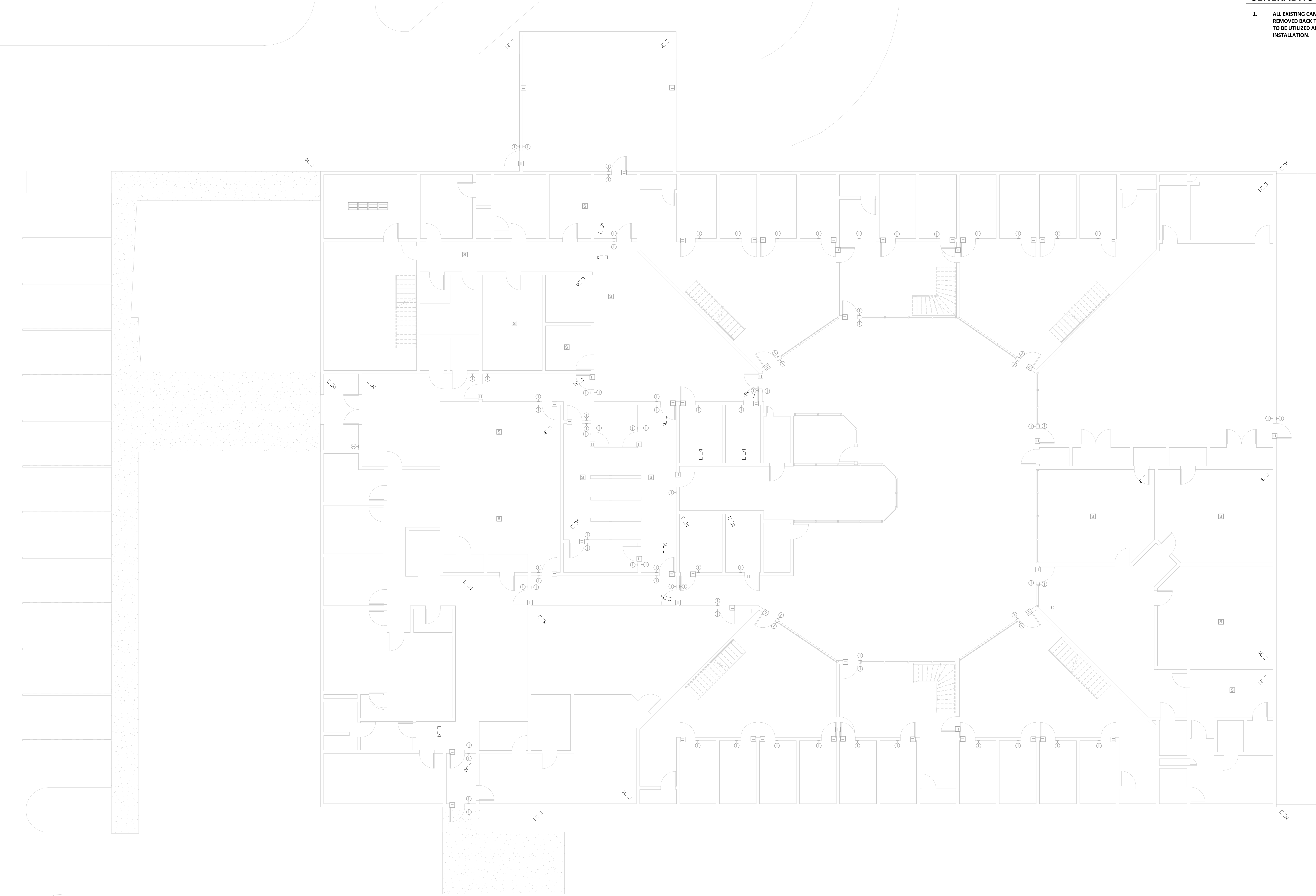

FIRST FLOOR - DEMOLITION - TECHNOLOGY

SCALE: 1/8" = 1'-0"



12/3/2019 4:23:17 PM  
C:\Users\dschultz\Documents\7261 - MEP19 - CentralJ.D.Schultz.rvt  
GHR # 7261 - CHAMPAIGN COUNTY COURTHOUSE & JUVENILE DETENTION CENTER SECURITY CAMERA AND MASTER CONTROL SYSTEMS UPGRADE

DATE	NO.	DESCRIPTION

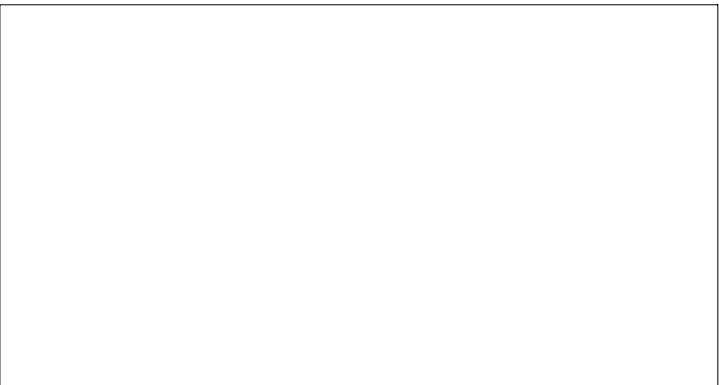

J.D.C. - FIRST FLOOR PLAN - DEMOLITION - TECHNOLOGY
CHAMPAIGN COUNTY COURTHOUSE & JUVENILE DETENTION CENTER- SECURITY CAMERA AND MASTER CONTROL SYSTEMS UPGRADE
CHAMPAIGN COUNTY 400 ART BARTELL RD, URBANA, IL 61802



DRAWN: DES	APPROVED: LEM
DATE: 12/4/2019	
BID DOCUMENTS	
PROJECT: GHR # 7261	

SHEET:
TD101.2

1. ALL EXISTING CAMERAS ARE TO BE DISCONNECTED AND WIRING IS TO BE REMOVED BACK TO NETWORK RACK. EXISTING PATHWAYS AND MOUNTING TO BE UTILIZED AND REUSED AS POSSIBLE DURING FOR NEW CAMERA INSTALLATION.

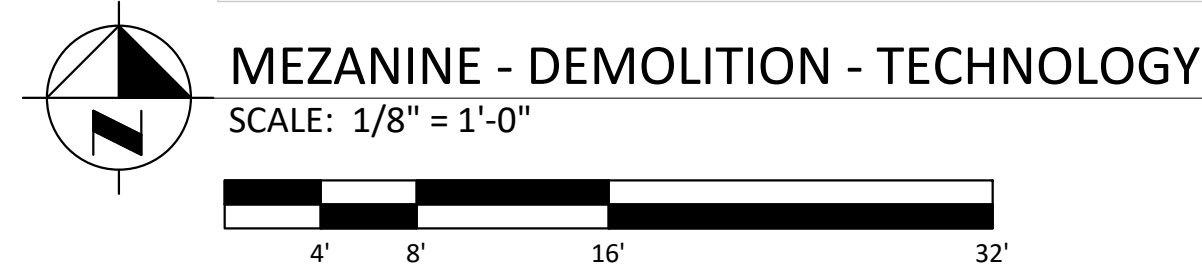

	DRAWN:	DES	APPROVED:	LEM
	DATE:	12/4/2019		
	BID DOCUMENTS			
	PROJECT:	GHR # 7261		
	SHEET:			
	TD102.2			



GENERAL NOTES - TECHNOLOGY

1. ALL NEW CAMERAS ON THIS PLAN THAT ARE SHOWN TO OCCUPY THE SAME POSITION AND DIRECTION AS THOSE ON THE TECHNOLOGY DEMOLITION PLANS ARE TO BE WIRED THROUGH EXISTING PATHWAYS SERVING OLD DEVICES IF POSSIBLE. REUSE EXISTING MOUNTING AND SHIELDING IF POSSIBLE.
2. NEW CAMERAS NOT REPLACING THOSE THAT WERE EXISTING ARE TO BE WIRED THROUGH NEW PATHWAYS TO EXISTING NETWORK RACK SHOWN ON SHEET "T101 - FIRST FLOOR PLAN - NEW WORK - TECHNOLOGY".

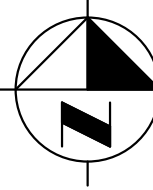
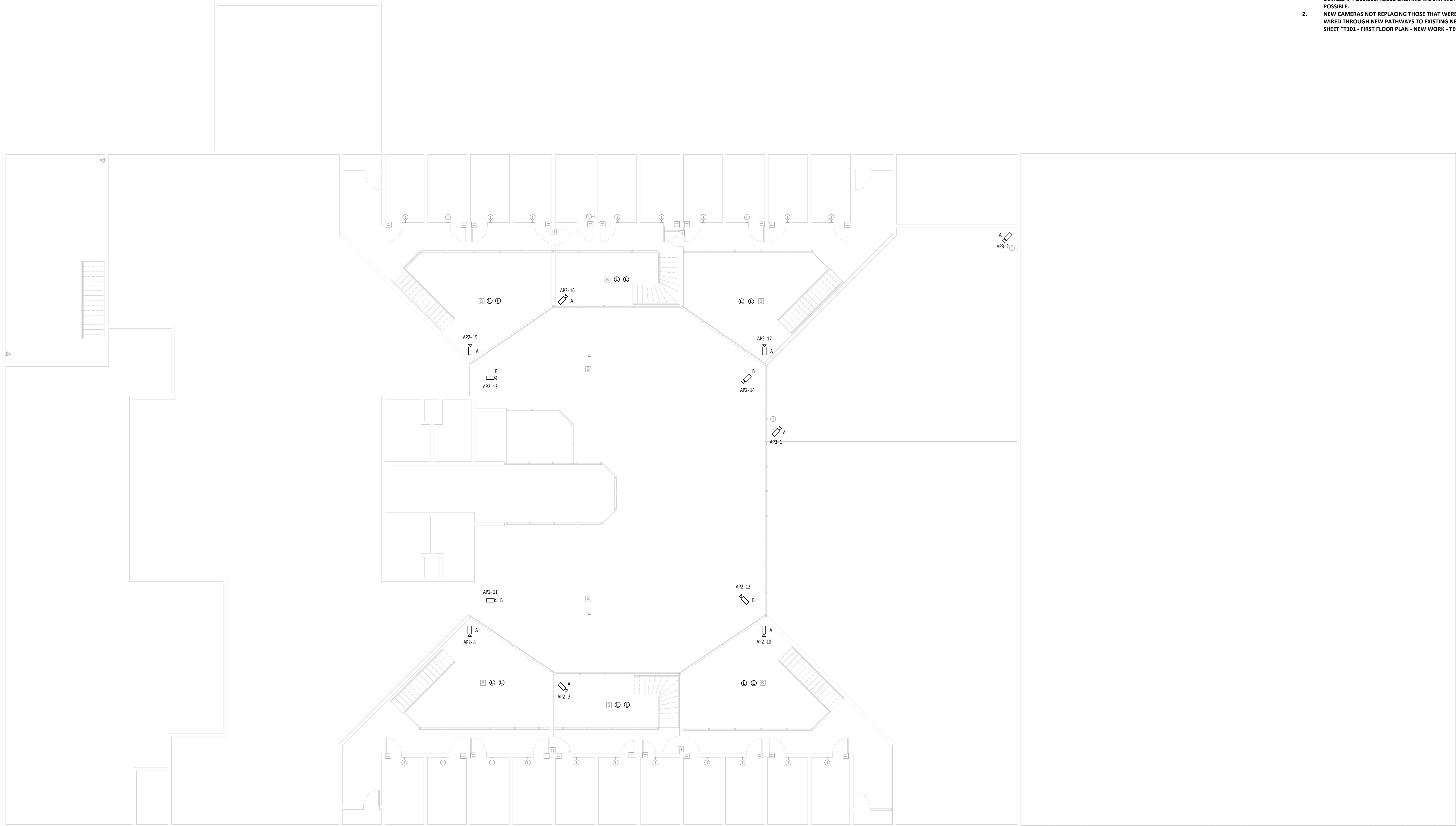

MEZANINE - NEW WORK - TECHNOLOGY  
SCALE: 1/8" = 1'-0"



12/3/2019 4:23:38 PM  
C:\Users\dschultz\Documents\7261 - MEP19 - Central2 - Dischultz.rvt  
GHR # 7261 - CHAMPAIGN COUNTY COURTHOUSE & JUVENILE DETENTION CENTER SECURITY CAMERA AND MASTER CONTROL SYSTEMS UPGRADE

DATE	NO.	DESCRIPTION

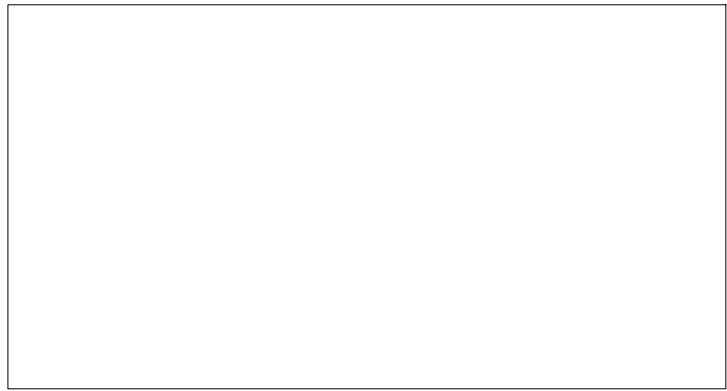

J.D.C. - MEZANINE PLAN - NEW WORK - TECHNOLOGY
CHAMPAIGN COUNTY COURTHOUSE & JUVENILE DETENTION CENTER- SECURITY CAMERA AND MASTER CONTROL SYSTEMS UPGRADE
CHAMPAIGN COUNTY 400 ART BARTELL RD, URBANA, IL 61802

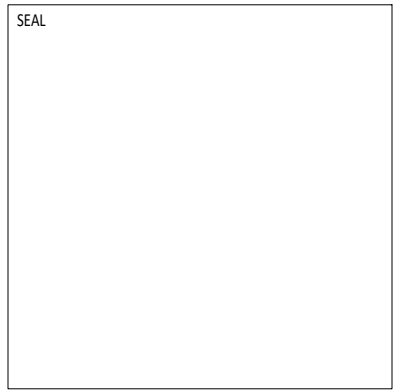

DRAWN: DES	APPROVED: LEM
DATE: 12/4/2019	
BID DOCUMENTS	
PROJECT: GHR # 7261	

SHEET:
T102.2